

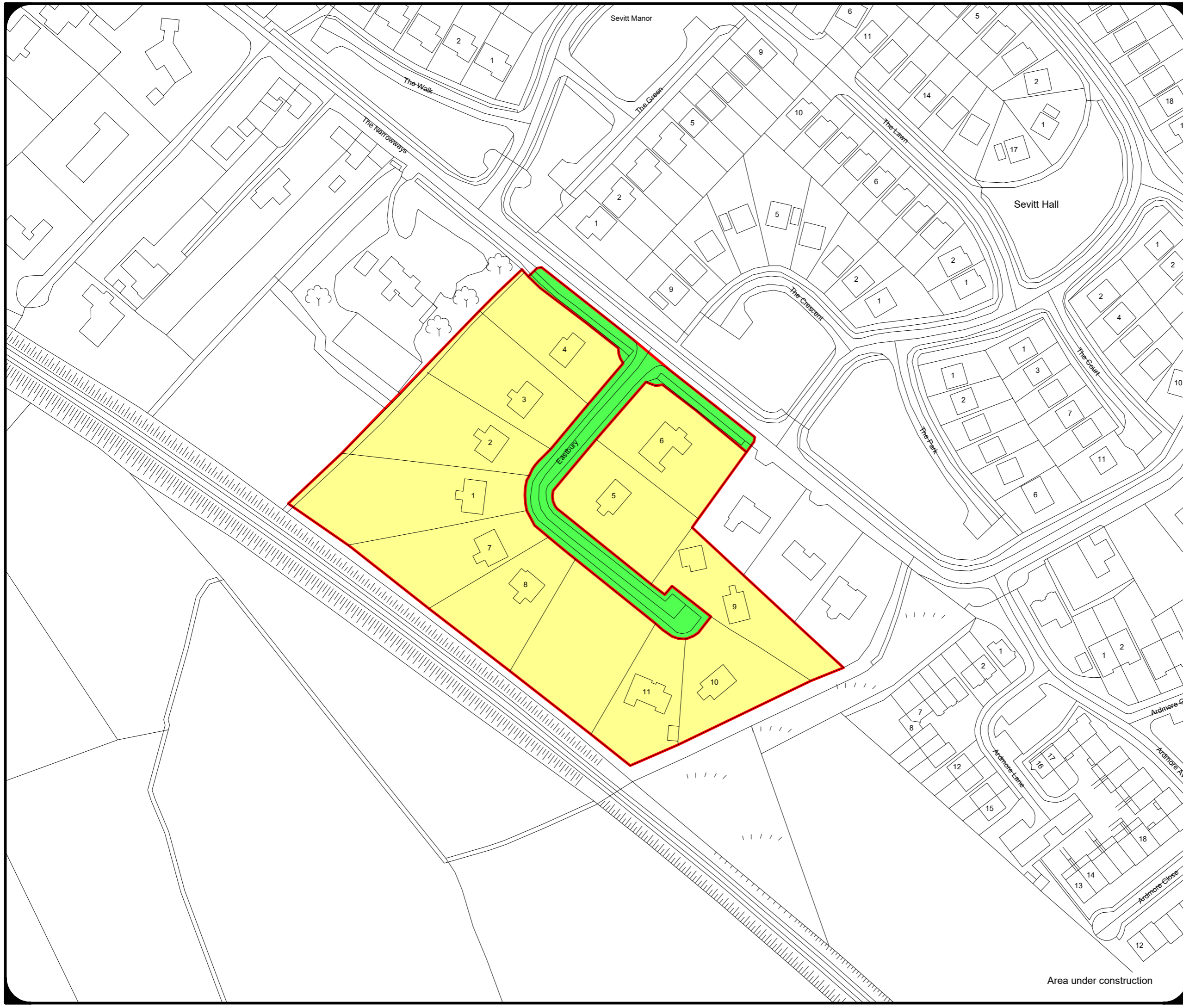

Map Extracted from Ordnance Survey Ireland (OSi) Vector Mapping



LEGEND

- Outline of Areas NOT to be taken in charge pursuant to the Planning and Development Acts as amended & Roads Act 1993
- Outline of Areas to be taken in charge pursuant to the Planning and Development Acts as amended & Roads Act 1993

Date:-	Jan 2020
Municipal District :-	Laytown / Bettystown
Location:-	Eastbury Bettystown Co. Meath
Produced by:-	CG
Scale:-	NTS

Note: Details shown on this map is for information purposes only. Further details on any item should be clarified with Meath County Council. This map has been produced by Meath County Council with available Local Authority and Ordnance Survey base data.
 © Ordnance Survey Ireland & Government of Ireland, Meath CCMA 2014/31
 NOTE - UNAUTHORISED REPRODUCTION OF THIS MAP INFRINGES STATE COPYRIGHT.

Contact:
 Planning Department
 Meath County Council
 Buvinda House
 Dublin Road,
 Navan, Co. Meath
 C15 Y291
 Tel: (046) 9097000
 Fax: (046) 9097001
 e-mail: planning@meathcoco.ie

Mapinfo File:
 F:\USERS\Planning Enforcement\UID - Unauthorised Development

Area under construction