

AREA 5

LEGEND

TREE CONDITION CATEGORIES

- A TREES OF HIGH VALUE AND QUALITY
- B TREES OF MODERATE VALUE AND QUALITY
- C TREES OF LOW QUALITY AND VALUE
- U TREES OF VERY LOW VALUE AND QUALITY TO BE REMOVED IN THE INTERESTS OF SOUND ARBORICULTURAL MANAGEMENT

- TREE CONSTRAINTS
- SITE BOUNDARY

Drawing to be interpreted with reference to Tree Survey document

Tree constraints shown are calculated from guidelines contained within BS5837 (2012) within dimensions contained within Section 8 of the Tree Survey document. This outline should not be interpreted as the exact extent of root spread however it is considered the optimal area to be retained free of developmental impacts. Natural and/or man made barriers such as waterlogged soil or buildings may restrict the spread of tree roots. Crown spreads may also prove to be a constraint particularly where crown reduction may not be possible. The constraints lines shown on this drawing are therefore a guide only. An on-site assessment should be undertaken in the event of any developments being planned within the areas shown for retained trees.



AREA 6

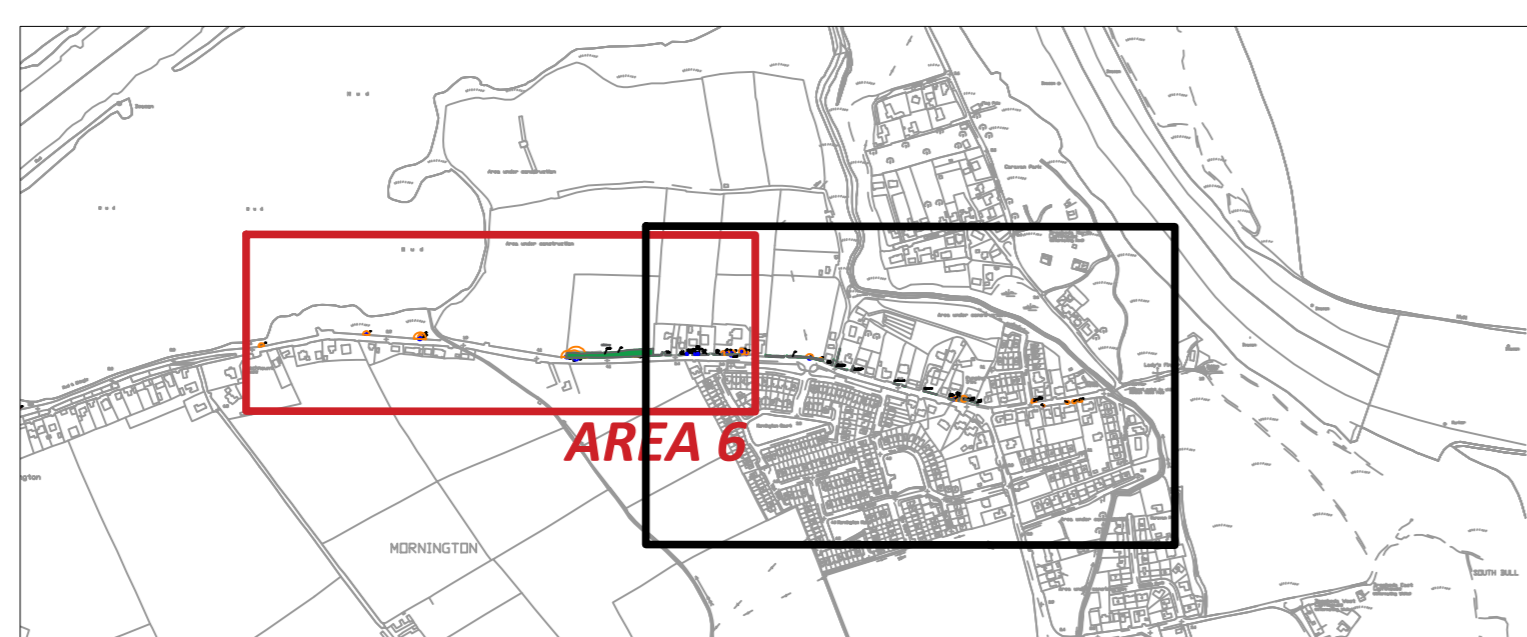
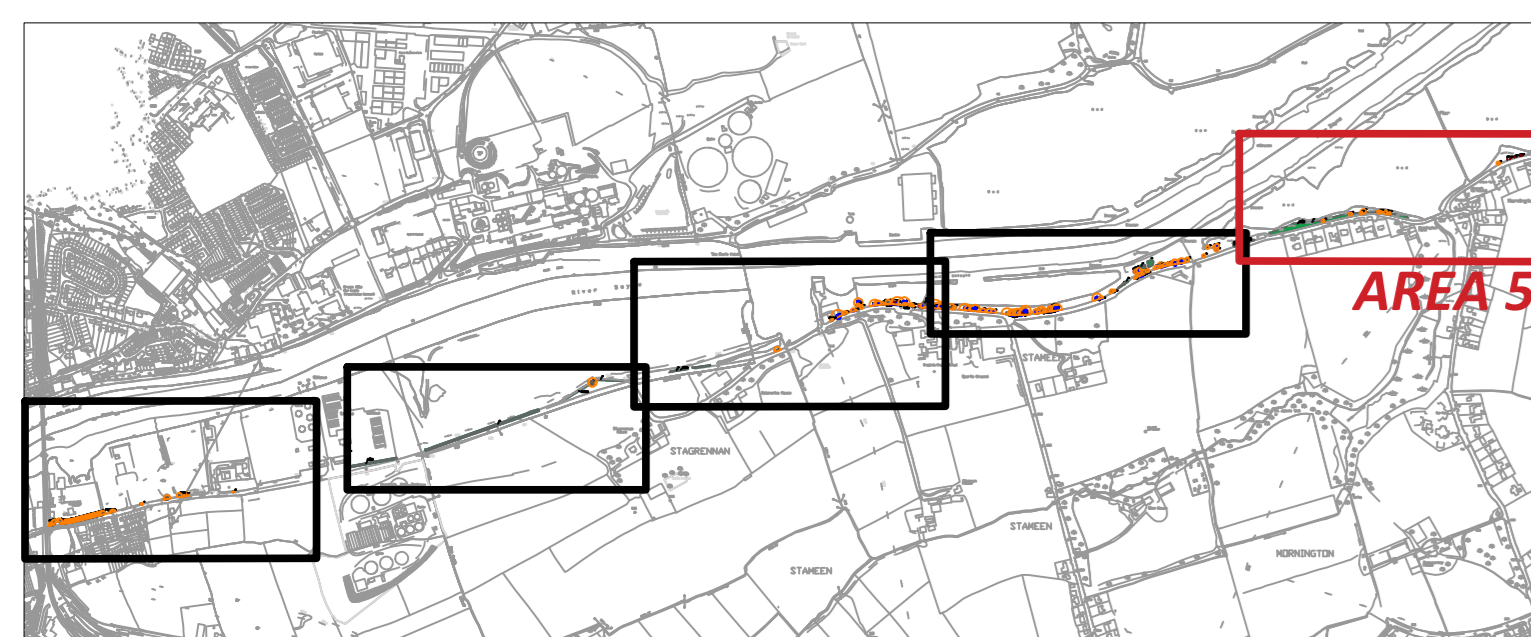
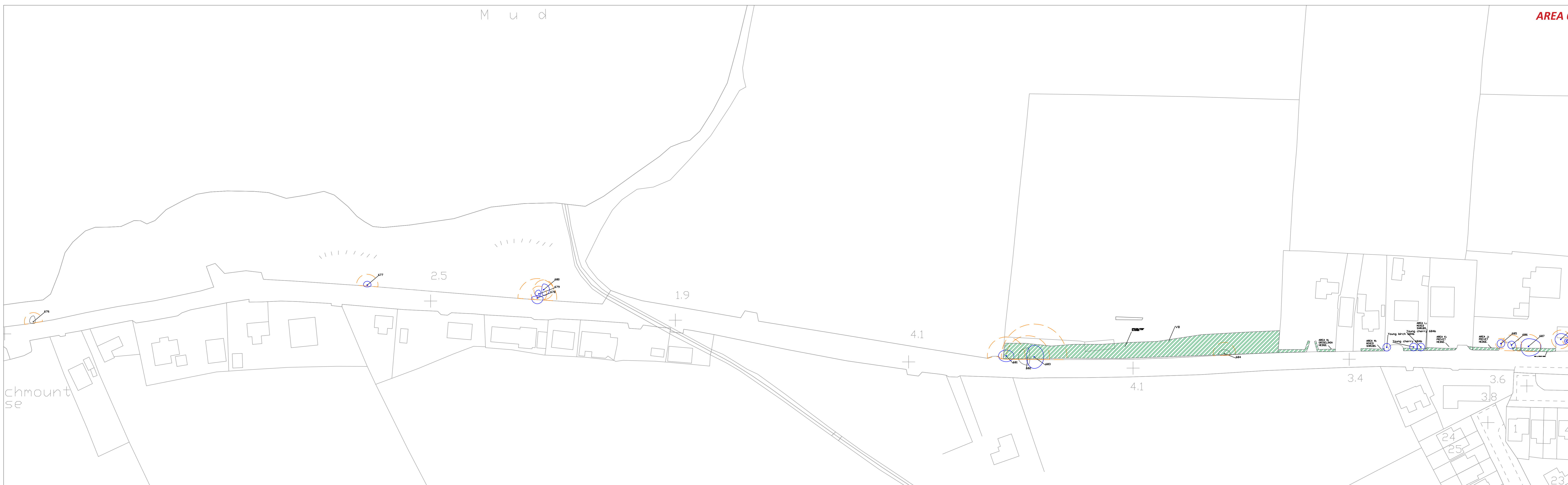

REV	DATE	DESCRIPTION

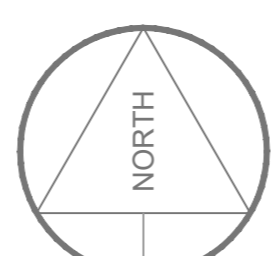

CMK Horticulture & Arboriculture Ltd.		CLIENT:	PROJECT:	JOB NO:
		MEATH COUNTY COUNCIL	BOYNE GREENWAY, CO. LOUTH	TBOY001
		DRAWING:	DATE:	SCALE:
		TREE SURVEY & CONSTRAINTS - (3 OF 4)	15-06-20	1:2000@A0
		DRAWN BY:	NMB	REVISION:
		NALL MCBRIDE	INITIALS	A
		STATUS: INFORMATION		

Do Not Scale. Use Figure Dimensions Only.
Not to Construct. Property owner Identification Marked.
© This Drawing is Copyright of CMK Horticulture & Arboriculture