

THE PROPOSED ACCESS TO LOCAL BUSINESSES AND PROPERTIES COMPLY WITH THE DMURS VISIBILITY SPLAY 2.4m x 49m SIGHTLINE) AND TII'S RURAL CYCLE MANUAL DN-GEO-03047 (2.0m x 15m). REFER TO DBFL DRAWINGS 170029-2700 AND 170029-2701 INCLUDED IN THE PLANNING PACKAGE.

© COPYRIGHT OF THIS DRAWING IS RESERVED BY DBFL CONSULTING ENGINEERS. NO PART SHALL BE REPRODUCED OR TRANSMITTED WITHOUT THEIR WRITTEN PERMISSION.

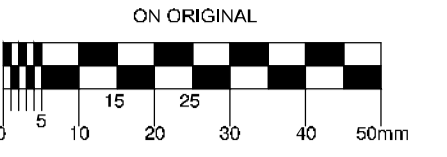

- NOTES:
- GENERAL NOTES:
1. ALL CO-ORDINATES ARE TO IRISH NATIONAL GRID (BASED ON OS MAPPING).
  2. ALL LEVELS ARE TO ORDNANCE DATUM MALIN HEAD (BASED ON LIDAR SURVEY INFORMATION).
  3. ALL DIMENSIONS IN METRES UNLESS SPECIFIED OTHERWISE.

LEGEND:

- TYPE A CONSTRUCTION SECTION BUILDINGS CONSTRUCTION (ALONGSIDE ROAD)
- PROPOSED FOOTPATH
- PROPOSED HEDGING
- EXISTING RIVER / WATER COURSE
- EXISTING ROAD
- EXISTING FOOTPATH
- RAISED TABLE
- PROPOSED DROP KERB
- PROPOSED WALL
- EXISTING BOUNDARY TREATMENT
- PROPOSED POST AND RAIL BOUNDARY
- PROPOSED WALL RAILING
- EXISTING ROAD LEVEL
- PROPOSED GREENWAY LEVEL
- BIROCODE

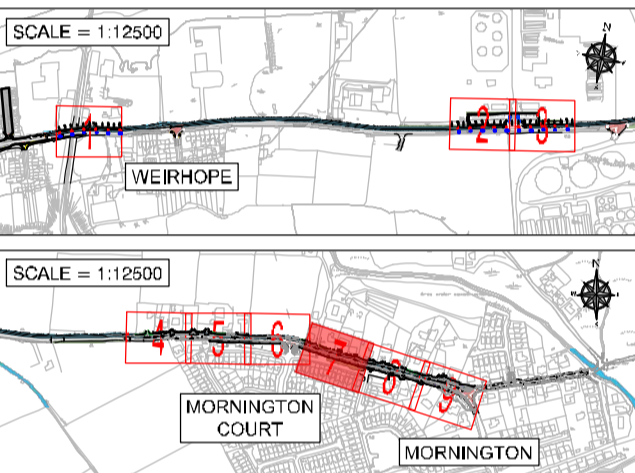

KEYPLAN

ORDNANCE SURVEY IRELAND LICENCE  
No EN 0017622  
© ORDNANCE SURVEY IRELAND  
GOVERNMENT OF IRELAND

REV.	DATE	DESCRIPTION	BY	CHKD.
P02	03-03-22	Issued As Part Of RFI	JP	MK
P01	13-01-22	Additional Sheets Added	JP	MK

REQUEST FOR FURTHER INFORMATION

DESIGNED	PREPARED	CHECKED	DATE
MK	JP	JP	13-01-2022

PROJECT

BOYNE GREENWAY

DROGHEDA TO MORNINGTON

DRG. TITLE

ACCOMODATION WORKS - LOCAL ACCESS

SHEET 7 OF 9

CLIENT

SCALE: 1:150 @A1 FILE REF. 170029-2400

DRG. NO. 170029-2406 P02

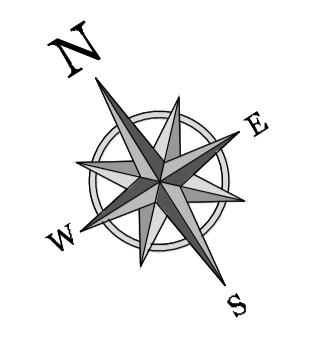
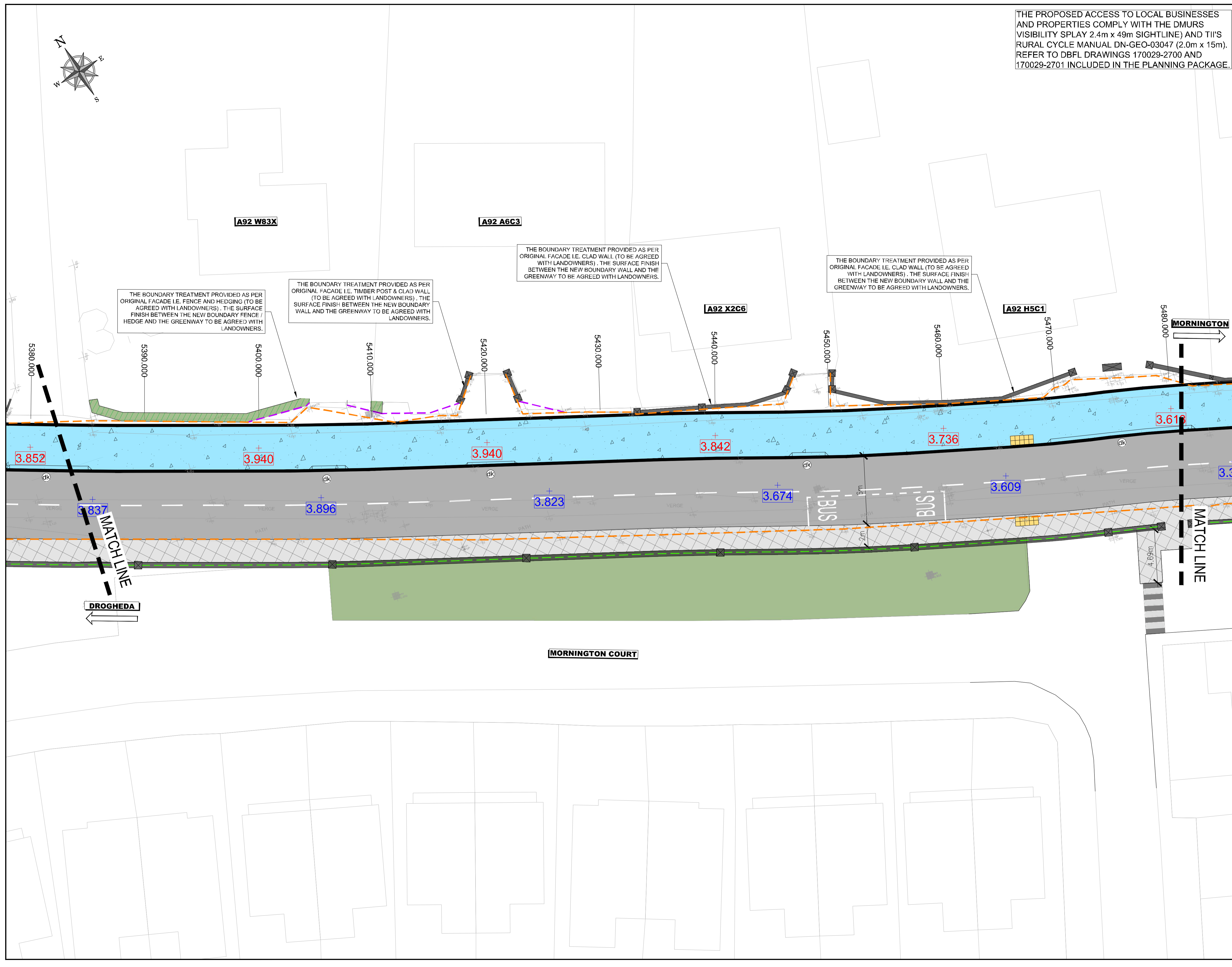

THE BOUNDARY TREATMENT PROVIDED AS PER ORIGINAL FACADE I.E. FENCE AND HEDGING (TO BE AGREED WITH LANDOWNERS). THE SURFACE FINISH BETWEEN THE NEW BOUNDARY FENCE / HEDGE AND THE GREENWAY TO BE AGREED WITH LANDOWNERS.

THE BOUNDARY TREATMENT PROVIDED AS PER ORIGINAL FACADE I.E. TIMBER POST & CLAD WALL (TO BE AGREED WITH LANDOWNERS). THE SURFACE FINISH BETWEEN THE NEW BOUNDARY WALL AND THE GREENWAY TO BE AGREED WITH LANDOWNERS.

THE BOUNDARY TREATMENT PROVIDED AS PER ORIGINAL FACADE I.E. CLAD WALL (TO BE AGREED WITH LANDOWNERS). THE SURFACE FINISH BETWEEN THE NEW BOUNDARY WALL AND THE GREENWAY TO BE AGREED WITH LANDOWNERS.

THE BOUNDARY TREATMENT PROVIDED AS PER ORIGINAL FACADE I.E. CLAD WALL (TO BE AGREED WITH LANDOWNERS). THE SURFACE FINISH BETWEEN THE NEW BOUNDARY WALL AND THE GREENWAY TO BE AGREED WITH LANDOWNERS.