

Legend

- ZONE 1 CHAINAGE 0 - 340
- ZONE 2 CHAINAGE 340 - 980
- ZONE 3 CHAINAGE 980 - 1750
- ZONE 4 CHAINAGE 1750 - 2150
- ZONE 5 CHAINAGE 2150 - 3100
- ZONE 6 CHAINAGE 3100 - 3600
- ZONE 7 CHAINAGE 3600 - 3900
- ZONE 8 CHAINAGE 3900 - 4750
- ZONE 9 CHAINAGE 4750 - 5100
- ZONE 10 CHAINAGE 5100 - 5870
- FOR LANDSCAPE ZONES REFER TO LVIA DESCRIPTION LANDSCAPE TREATMENT
- EXISTING RIVER / WATER COURSE
- SPECIAL PROTECTION AREA (SPA)
- SPECIAL AREA OF CONSERVATION (SAC)

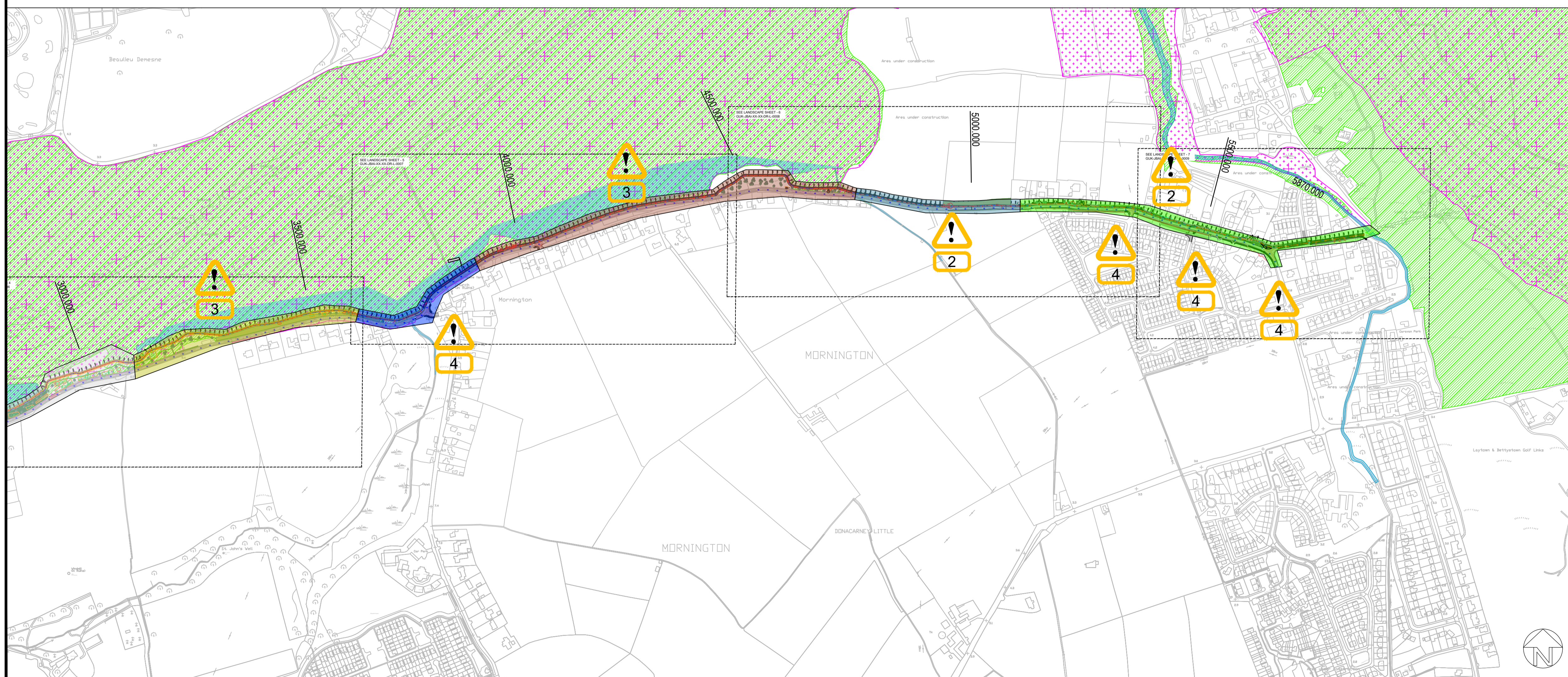

DESIGN HAZARDS

- ! 1. U/G UTILITIES
- 2 2. O/H CABLES
- 3 3. OPEN WATER BODY
- 4 4. LIVE TRAFFIC

Note:
 DESIGN HAZARDS HAVE NOT BEEN CONSIDERED AT THIS STAGE OF THE DESIGN

Unit 8
 Block 660
 Greenogue Business Plaza
 Greenogue Business Park
 Rathcoole
 Dublin D24 CY64
 T +353 (0)1 685 5595
 E info@jbaconsulting.com
 www.jbaconsulting.com
 Twitter @JBAConsulting



Project **Boyne Greenway LVIA**

Title **Landscape Detailed Layout - Sheet Layout**
 for

Client **Meath County Council**

The property of this drawing and design vested in Jeremy Benn Associates Ltd. It shall not be reproduced in whole or in part, nor disclosed to a third party, without the prior written consent of Jeremy Benn Associates Ltd.

Drawn: CZ	01/03/2022	Designed: CZ	16/02/2022
Checked: CP	01/03/2022	Approved: BOC	01/03/2022
Project Reference: 2021s1306		Scale: 1:5000 @ A1	
Drawing Number: GUK-JBAI-XX-DR-L-0002	Status: A3	Revision: C01	Sheet Size: A1

CHAINAGE: 0 - 300



CHAINAGE: 300 - 620

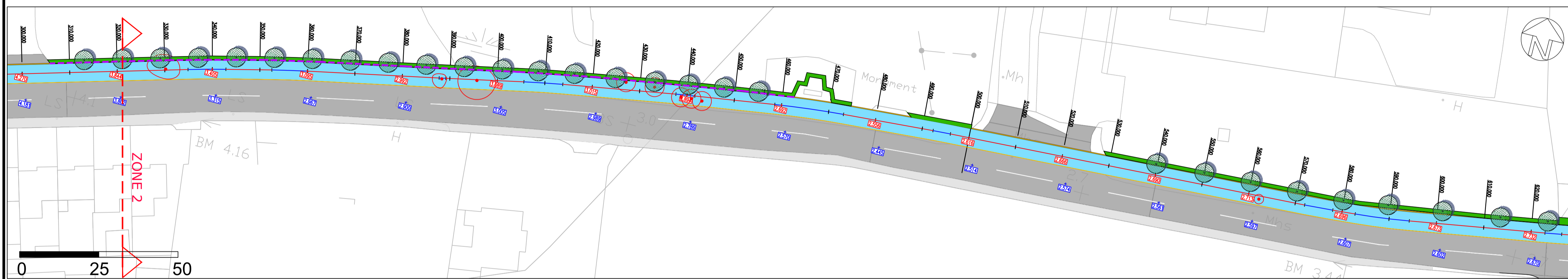

CHAINAGE: 620 - 940

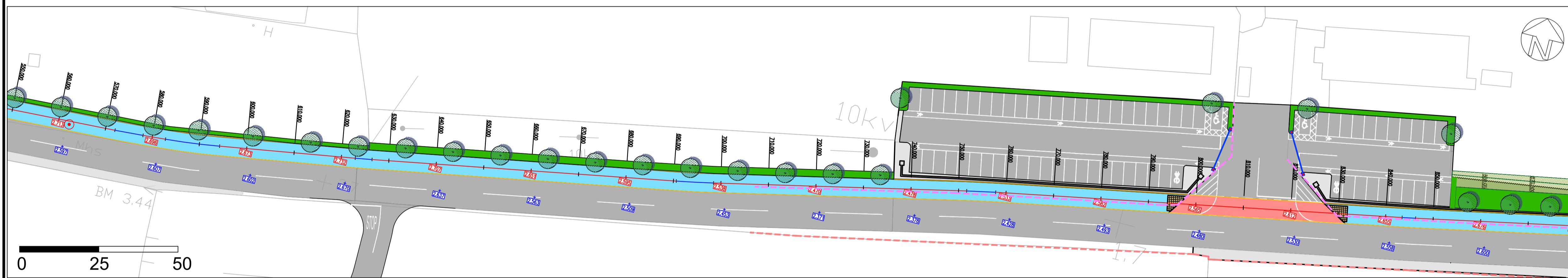

KEY PLAN CHAINAGE: 0 - 940

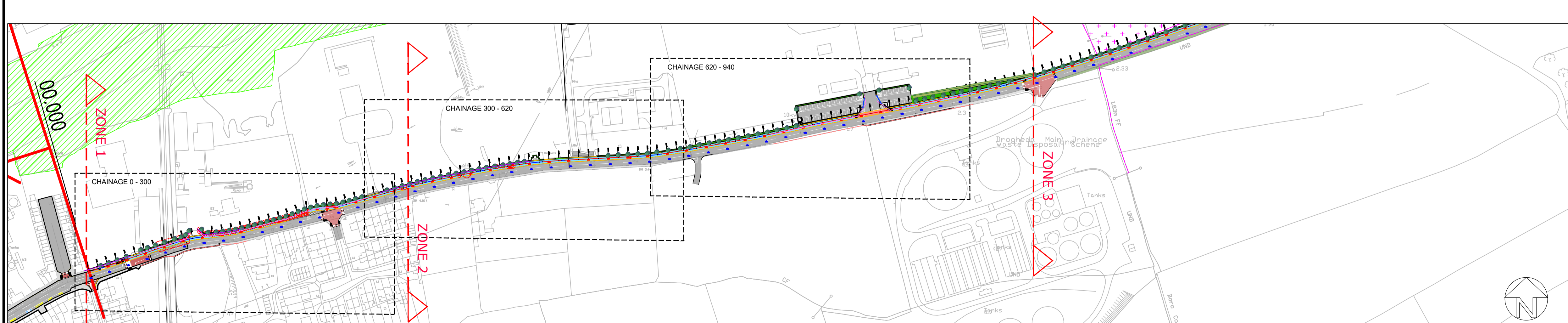

Legend

- SITE BOUNDARY
 - EXISTING TREE TO BE RETAINED, REFER TO ARBORICULTURA SURVEY
 - EXISTING TREE TO BE REMOVE, REFER TO ARBORICULTURA SURVEY
 - TREE PROTECTION FENCING REFER TO ARBORICULTURA SURVEY
 - EXISTING HEDGEROW TO BE RETAINED, REFER TO ARBORICULTURA SURVEY
 - EXISTING HEDGEROW TO BE REMOVE, REFER TO ARBORICULTURA SURVEY
 - PROPOSED NATIVE TREE PLANTING, REFER TO PLANTING SCHEDULE
 - PROPOSED NATIVE WOODLAND PLANTING, REFER TO PLANTING SCHEDULE
 - PROPOSED NATIVE LOW/MEDIUM SHRUB AND ORNAMENTAL GRASS PLANTING
 - PROPOSED NATIVE HEDGEROW, REFER TO PLANTING SCHEDULE
 - PROPOSED HEDGE PLANTING TO EXISTING FRONT GARDEN REFER TO PLANTING SCHEDULE
 - EXISTING BOUNDARY TREATMENT TO BE REMOVED
 - PROPOSED NEW BOUNDARY WALL TO EXISTING FRONT GARDEN
 - EXISTING MASONRY WALL
- REFER TO ENGINEER'S DETAIL
- TYPE A CONSTRUCTION SECTION BITUMINOUS CONSTRUCTION (ALONGSIDE ROAD)
 - TYPE B CONSTRUCTION SECTION BITUMINOUS CONSTRUCTION (AWAY FROM ROAD)
 - TYPE C CONSTRUCTION SECTION BOARDWALK CONSTRUCTION
 - TYPE D CONSTRUCTION SECTION LOCAL BRIDGE
 - PROPOSED FOOTPATH
 - EXISTING RIVER / WATER COURSE
 - EXISTING ROAD
 - EXISTING FOOTPATH
 - RAISED TABLE
 - SPECIAL PROTECTION AREA (SPA)
 - SPECIAL AREA OF CONSERVATION (SAC)
 - FOR LANDSCAPE ZONES REFER TO LVIA DESCRIPTION LANDSCAPE TREATMENT

Note:
FOR CHAINAGE REFER TO ENGINEERING DRAWINGS

Unit 8
Block 660
Greenogue Business Plaza
Greenogue Business Park
Rathcoole
Dublin D24 CY64
T +353 (0)1 685 5595
E info@jbaconsulting.com
www.jbaconsulting.com
Twitter @JBAConsulting



Project **Boyne Greenway LVIA**

Title **Landscape Detailed Layout - Sheet -1**
for

Client **Meath County Council**

The property of this drawing and design vested in Jeremy Benn Associates Ltd. It shall not be reproduced in whole or in part, nor disclosed to a third party, without the prior written consent of Jeremy Benn Associates Ltd.

Drawn: CZ	01/03/2022	Designed: CZ	07/01/2022
Checked: CP	01/03/2022	Approved: BOC	01/03/2022
Project Reference: 2021s1306	Scale: 1:500 @ A1		
Drawing Number: GUK-JBAI-XX-XX-DR-L-0003	Status: A3	Revision: C01	Sheet Size: A1

CHAINAGE: 940 - 1250

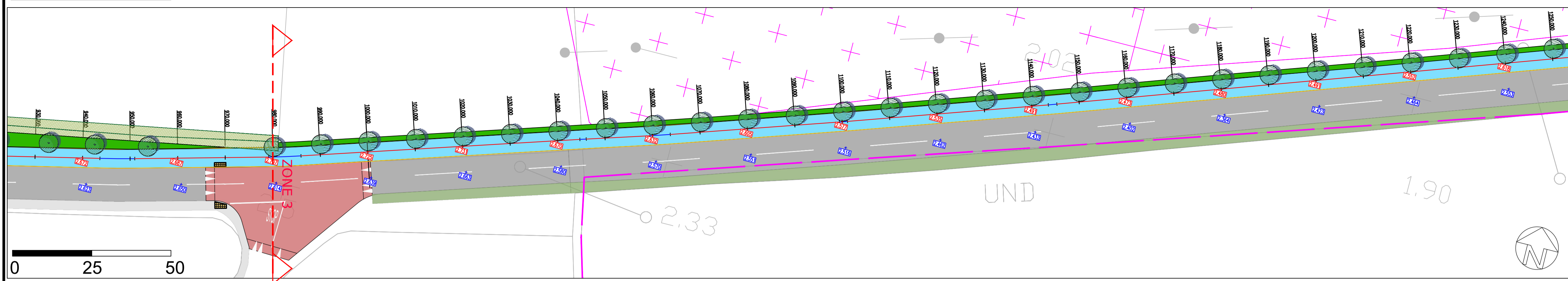

CHAINAGE: 1250 - 1560

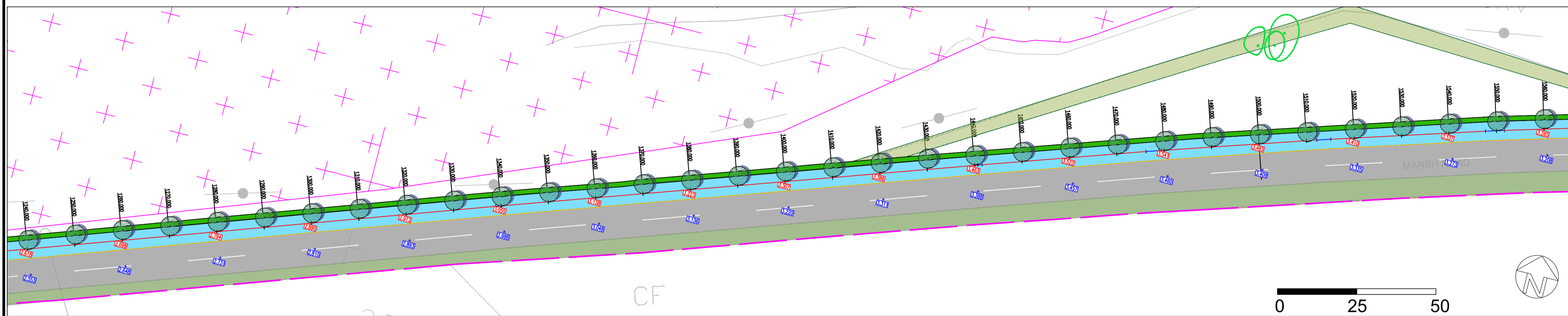

CHAINAGE: 1560 - 1880

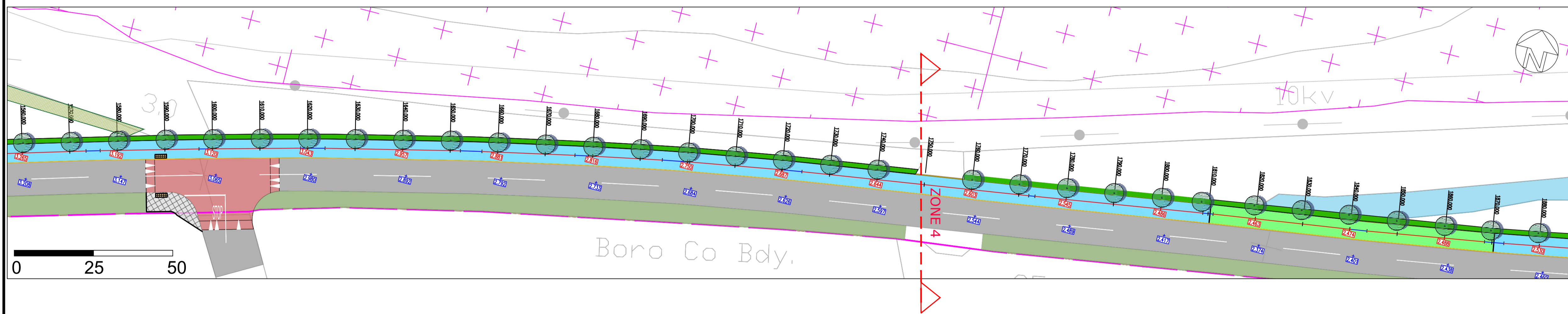

KEY PLAN CHAINAGE: 940 - 1880

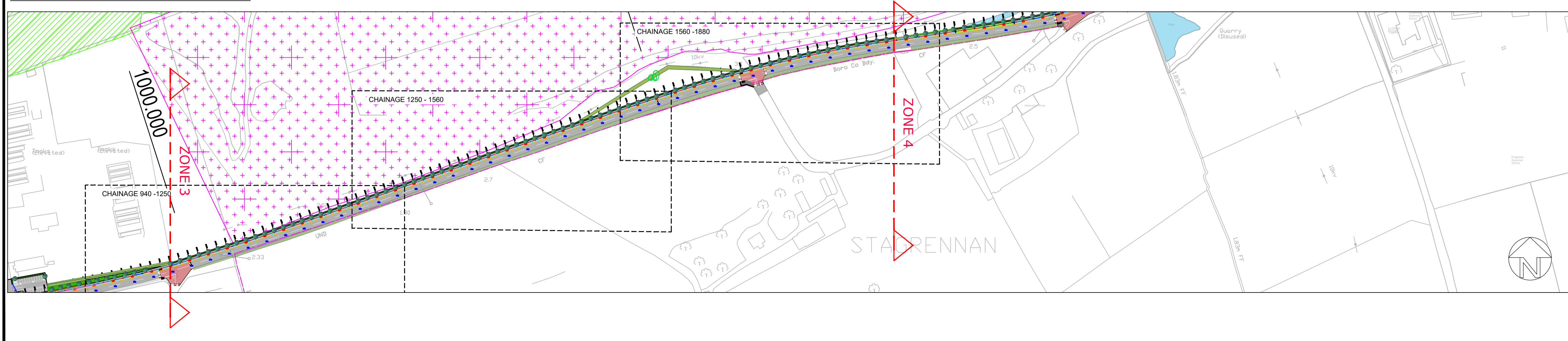

Legend

- SITE BOUNDARY
 - EXISTING TREE TO BE RETAINED, REFER TO ARBORICULTURA SURVEY
 - EXISTING TREE TO BE REMOVE, REFER TO ARBORICULTURA SURVEY
 - TREE PROTECTION FENCING REFER TO ARBORICULTURA SURVEY
 - EXISTING HEDGEROW TO BE RETAINED, REFER TO ARBORICULTURA SURVEY
 - EXISTING HEDGEROW TO BE REMOVE, REFER TO ARBORICULTURA SURVEY
 - PROPOSED NATIVE TREE PLANTING, REFER TO PLANTING SCHEDULE
 - PROPOSED NATIVE WOODLAND PLANTING, REFER TO PLANTING SCHEDULE
 - PROPOSED NATIVE LOW/MEDIUM SHRUB AND ORNAMENTAL GRASS PLANTING
 - PROPOSED NATIVE HEDGEROW, REFER TO PLANTING SCHEDULE
 - EXISTING MASONRY WALL
- REFER TO ENGINEER'S DETAIL
- TYPE A CONSTRUCTION SECTION BITUMINOUS CONSTRUCTION (ALONGSIDE ROAD)
 - TYPE B CONSTRUCTION SECTION BITUMINOUS CONSTRUCTION (AWAY FROM ROAD)
 - TYPE C CONSTRUCTION SECTION BOARDWALK CONSTRUCTION
 - TYPE D CONSTRUCTION SECTION LOCAL BRIDGE
 - PROPOSED FOOTPATH
 - EXISTING RIVER / WATER COURSE
 - EXISTING ROAD
 - EXISTING FOOTPATH
 - RAISED TABLE
 - SPECIAL PROTECTION AREA (SPA)
 - SPECIAL AREA OF CONSERVATION (SAC)
 - FOR LANDSCAPE ZONES REFER TO LVIA DESCRIPTION LANDSCAPE TREATMENT

Note:
FOR CHAINAGE REFER TO ENGINEERING DRAWINGS

Unit 8
Block 660
Greenogue Business Plaza
Greenogue Business Park
Rathcoole
Dublin D24 CY64
T +353 (0)1 685 5595
E info@jbaconsulting.com
www.jbaconsulting.com
Twitter @JBAConsulting



Project	Boyne Greenway LVIA		
Title	Landscape Detailed Layout - Sheet -2		
Client	Meath County Council		

The property of this drawing and design vested in Jeremy Benn Associates Ltd. It shall not be reproduced in whole or in part, nor disclosed to a third party, without the prior written consent of Jeremy Benn Associates Ltd.			
Drawn: CZ	01/03/2022	Designed: CZ	07/01/2022
Checked: CP	01/03/2022	Approved: BOC	01/03/2022
Project Reference: 2021s1306	Scale: 1:500 @ A1		
Drawing Number: GUK-JBAI-XX-DR-L-0004	Status: A3	Revision: C01	Sheet Size: A1

CHAINAGE: 1880 - 2070

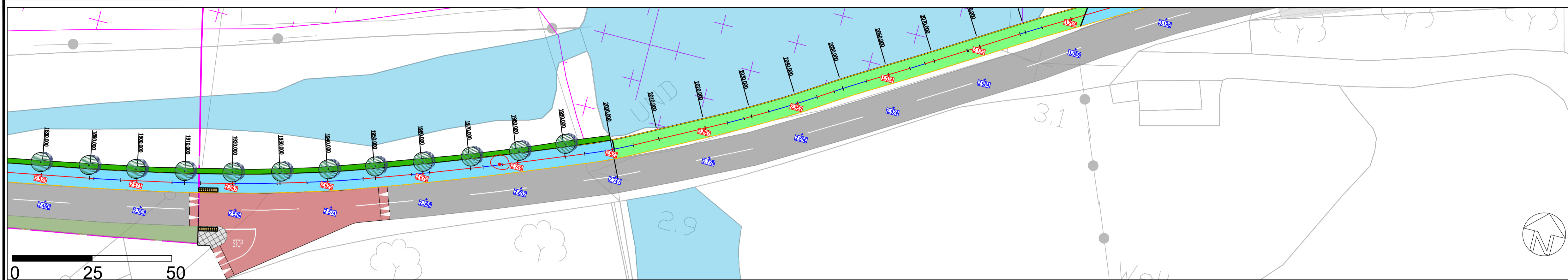

CHAINAGE: 2070 - 2390

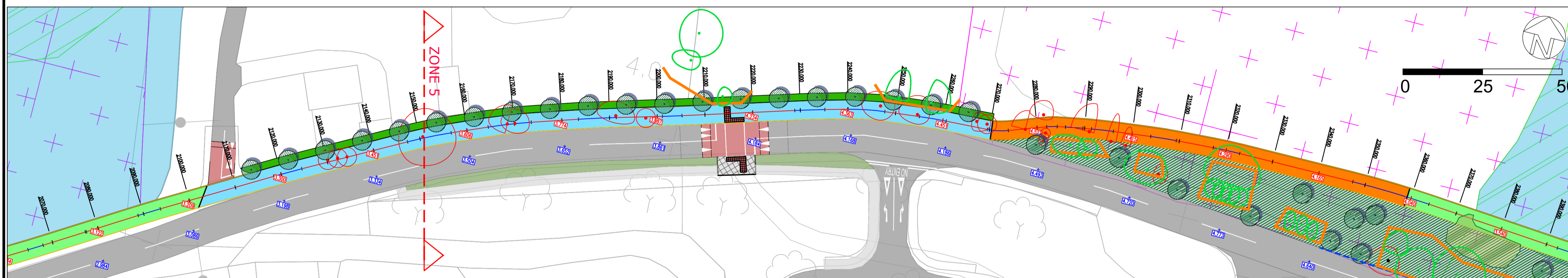

CHAINAGE: 2390 - 2700

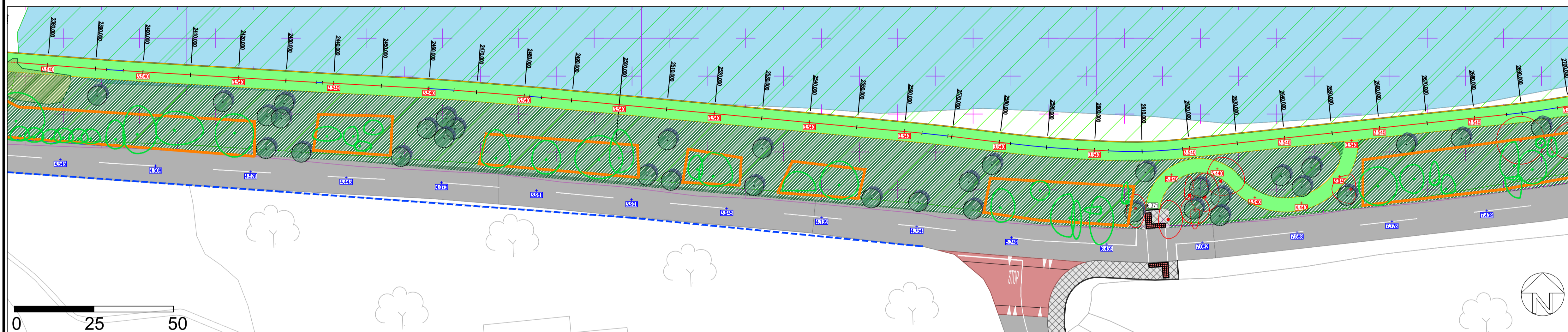

KEY PLAN CHAINAGE: 1880 - 2700

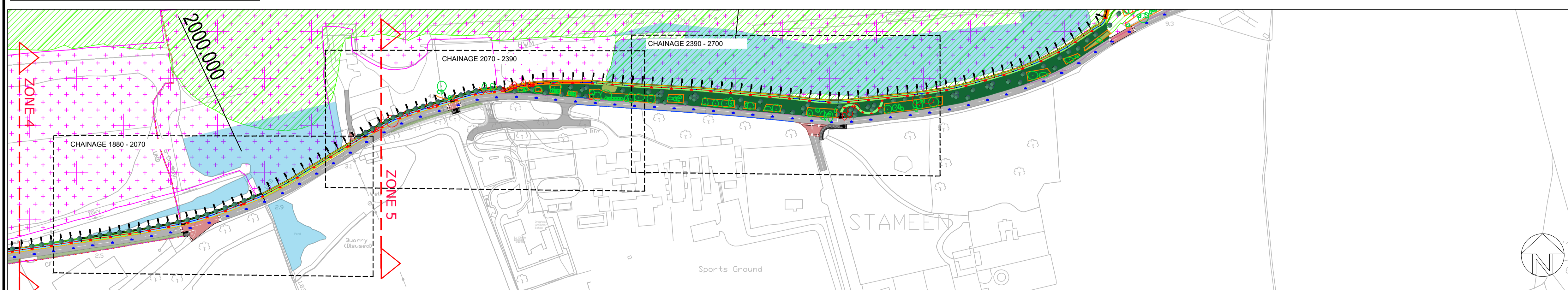

Legend

- SITE BOUNDARY
- EXISTING TREE TO BE RETAINED, REFER TO ARBORICULTURA SURVEY
- EXISTING TREE TO BE REMOVE, REFER TO ARBORICULTURA SURVEY
- TREE PROTECTION FENCING REFER TO ARBORICULTURA SURVEY
- EXISTING HEDGEROW TO BE RETAINED, REFER TO ARBORICULTURA SURVEY
- EXISTING HEDGEROW TO BE REMOVE, REFER TO ARBORICULTURA SURVEY
- PROPOSED NATIVE TREE PLANTING, REFER TO PLANTING SCHEDULE
- PROPOSED NATIVE WOODLAND PLANTING, REFER TO PLANTING SCHEDULE
- PROPOSED NATIVE LOW/MEDIUM SHRUB AND ORNAMENTAL GRASS PLANTING
- PROPOSED NATIVE HEDGEROW, REFER TO PLANTING SCHEDULE
- EXISTING MASONRY WALL
- REFER TO ENGINEER'S DETAIL**
- TYPE A CONSTRUCTION SECTION BITUMINOUS CONSTRUCTION (ALONGSIDE ROAD)
- TYPE B CONSTRUCTION SECTION BITUMINOUS CONSTRUCTION (AWAY FROM ROAD)
- TYPE C CONSTRUCTION SECTION BOARDWALK CONSTRUCTION
- TYPE D CONSTRUCTION SECTION LOCAL BRIDGE
- PROPOSED FOOTPATH
- EXISTING RIVER / WATER COURSE
- EXISTING ROAD
- EXISTING FOOTPATH
- RAISED TABLE
- SPECIAL PROTECTION AREA (SPA)
- SPECIAL AREA OF CONSERVATION (SAC)
- FOR LANDSCAPE ZONES REFER TO LVIA DESCRIPTION LANDSCAPE TREATMENT

Note:
FOR CHAINAGE REFER TO ENGINEERING DRAWINGS

Unit 8
Block 650
Greenogue Business Plaza
Greenogue Business Park
Rathcoole
Dublin D24 CY64
T +353 (0)1 685 5595
E info@jbaconsulting.com
www.jbaconsulting.com
Twitter @JBAConsulting



Project **Boyne Greenway LVIA**

Title **Landscape Detailed Layout - Sheet -3**

Client **Meath County Council**

The property of this drawing and design vested in Jeremy Benn Associates Ltd. It shall not be reproduced in whole or in part, nor disclosed to a third party, without the prior written consent of Jeremy Benn Associates Ltd.

Drawn: CZ	01/03/2022	Designed: CZ	07/01/2022
Checked: CP	01/03/2022	Approved: BOC	01/03/2022
Project Reference: 2021s1306	Scale: 1:500 @ A1		
Drawing Number: GUK-JBAI-XX-DR-L-0005	Status: A3	Revision: C01	Sheet Size: A1

CHAINAGE: 2700 - 2900

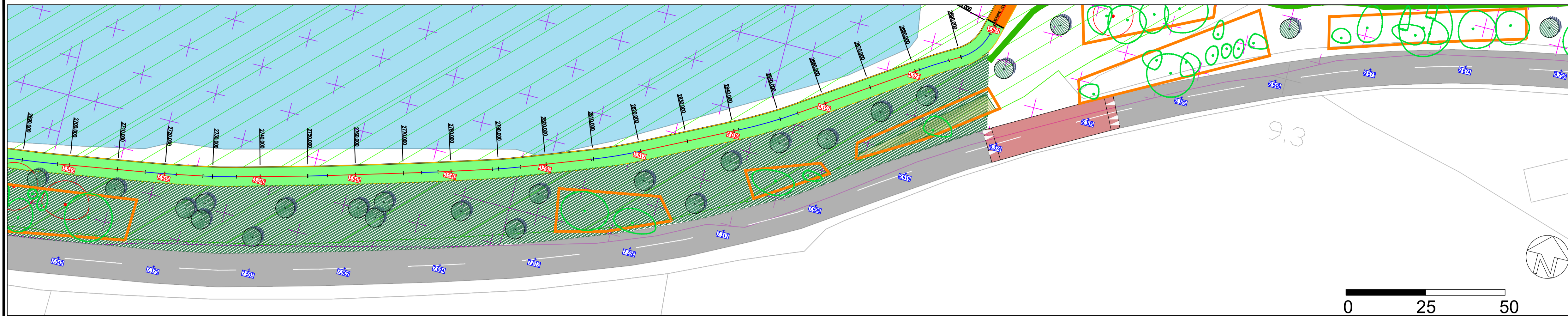

CHAINAGE: 2900 - 3200

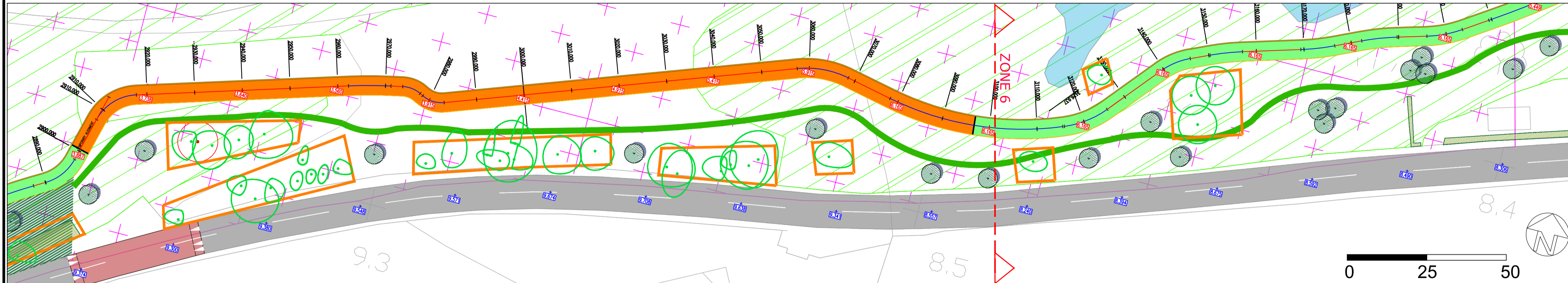

CHAINAGE: 3200 - 3520

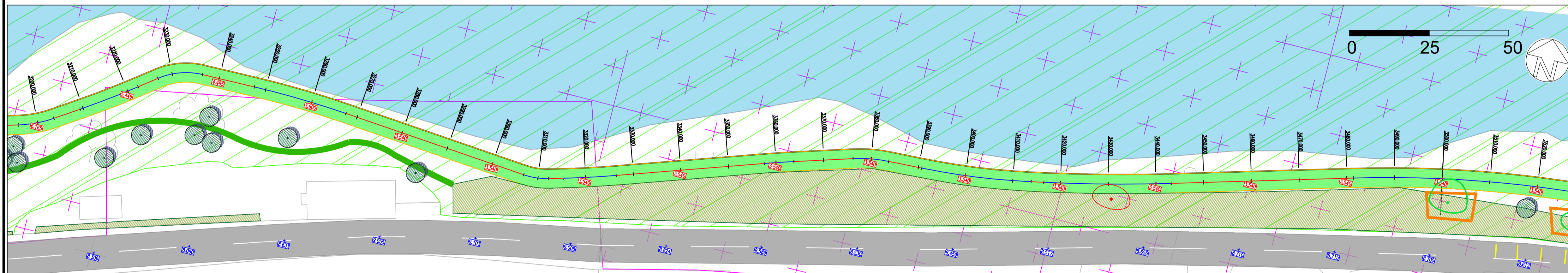

KEY PLAN CHAINAGE: 2700 - 3520

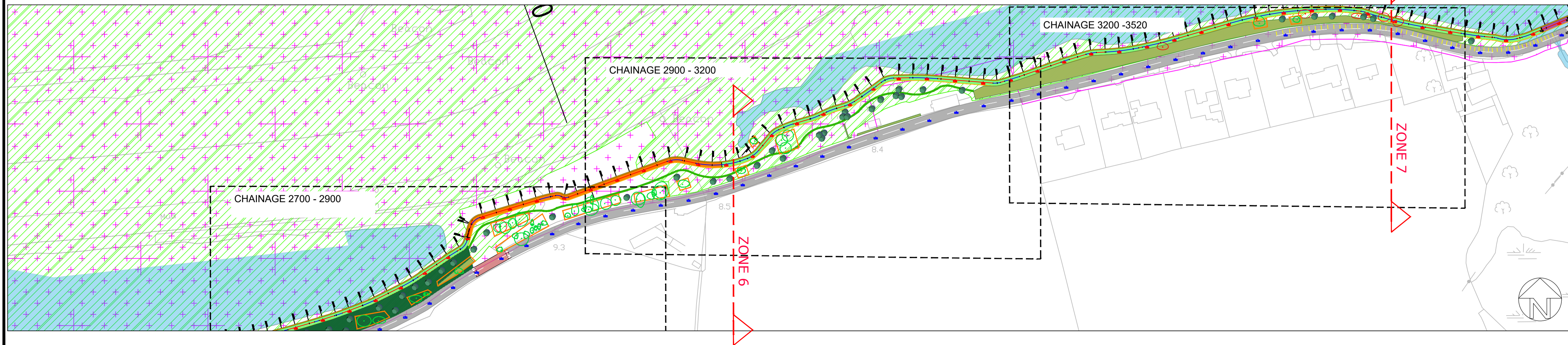

Legend

- SITE BOUNDARY
- EXISTING TREE TO BE RETAINED, REFER TO ARBORICULTURA SURVEY
- EXISTING TREE TO BE REMOVE, REFER TO ARBORICULTURA SURVEY
- TREE PROTECTION FENCING REFER TO ARBORICULTURA SURVEY
- EXISTING HEDGEROW TO BE RETAINED, REFER TO ARBORICULTURA SURVEY
- EXISTING HEDGEROW TO BE REMOVE, REFER TO ARBORICULTURA SURVEY
- PROPOSED NATIVE TREE PLANTING, REFER TO PLANTING SCHEDULE
- PROPOSED NATIVE WOODLAND PLANTING, REFER TO PLANTING SCHEDULE
- PROPOSED NATIVE LOW/MEDIUM SHRUB AND ORNAMENTAL GRASS PLANTING
- PROPOSED NATIVE HEDGEROW, REFER TO PLANTING SCHEDULE
- EXISTING MASONRY WALL
- REFER TO ENGINEER'S DETAIL
- TYPE A CONSTRUCTION SECTION BITUMINOUS CONSTRUCTION (ALONGSIDE ROAD)
- TYPE B CONSTRUCTION SECTION BITUMINOUS CONSTRUCTION (AWAY FROM ROAD)
- TYPE C CONSTRUCTION SECTION BOARDWALK CONSTRUCTION
- TYPE D CONSTRUCTION SECTION LOCAL BRIDGE
- PROPOSED FOOTPATH
- EXISTING RIVER / WATER COURSE
- EXISTING ROAD
- EXISTING FOOTPATH
- RAISED TABLE
- SPECIAL PROTECTION AREA (SPA)
- SPECIAL AREA OF CONSERVATION (SAC)
- FOR LANDSCAPE ZONES REFER TO LVIA DESCRIPTION LANDSCAPE TREATMENT

Note:
FOR CHAINAGE REFER TO ENGINEERING DRAWINGS

Unit 8
Block 660
Greenogue Business Plaza
Greenogue Business Park
Rathcoole
Dublin D24 CY64
T +353 (0)1 685 5595
E info@jbaconsulting.com
www.jbaconsulting.com
Twitter @JBAConsulting



Project **Boyne Greenway LVIA**

Title **Landscape Detailed Layout - Sheet -4**
for

Client **Meath County Council**

The property of this drawing and design vested in Jeremy Benn Associates Ltd. It shall not be reproduced in whole or in part, nor disclosed to a third party, without the prior written consent of Jeremy Benn Associates Ltd.

Drawn: CZ	01/03/2022	Designed: CZ	07/01/2022
Checked: CP	01/03/2022	Approved: BOC	01/03/2022
Project Reference: 2021s1306	Scale: 1:500 @ A1		
Drawing Number: GUK-JBAI-XX-XX-DR-L-0006	Status: A3	Revision: C01	Sheet Size: A1

CHAINAGE: 3520 - 3750

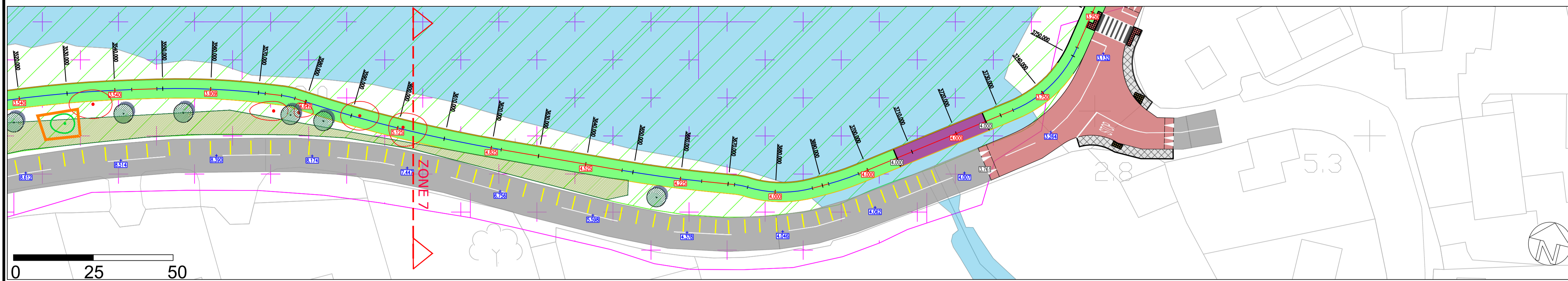

CHAINAGE: 3750 - 4050

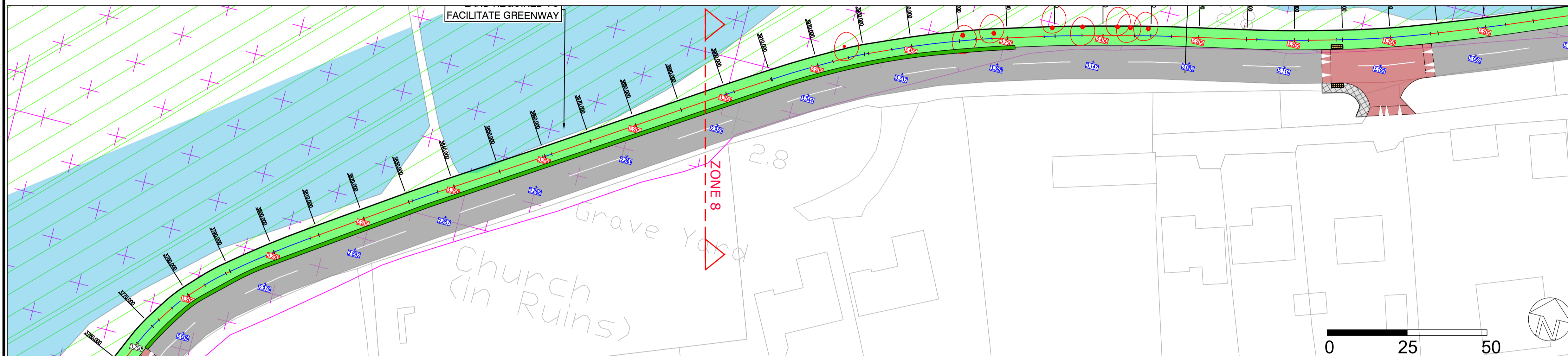

CHAINAGE: 4050 - 4370

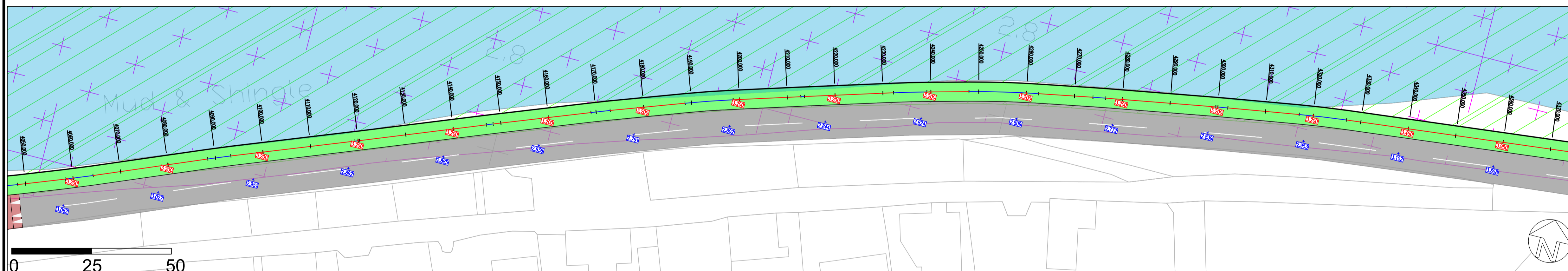

KEY PLAN CHAINAGE: 3520 - 4370

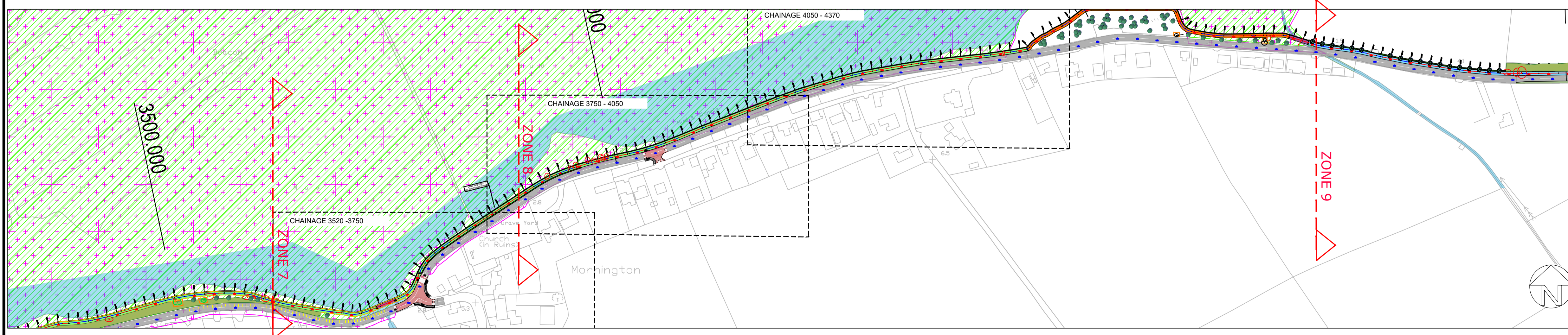

Legend

- SITE BOUNDARY
- EXISTING TREE TO BE RETAINED, REFER TO ARBORICULTURA SURVEY
- EXISTING TREE TO BE REMOVE, REFER TO ARBORICULTURA SURVEY
- TREE PROTECTION FENCING REFER TO ARBORICULTURA SURVEY
- EXISTING HEDGEROW TO BE RETAINED, REFER TO ARBORICULTURA SURVEY
- EXISTING HEDGEROW TO BE REMOVE, REFER TO ARBORICULTURA SURVEY
- PROPOSED NATIVE TREE PLANTING, REFER TO PLANTING SCHEDULE
- PROPOSED NATIVE WOODLAND PLANTING, REFER TO PLANTING SCHEDULE
- PROPOSED NATIVE LOW/MEDIUM SHRUB AND ORNAMENTAL GRASS PLANTING
- PROPOSED NATIVE HEDGEROW, REFER TO PLANTING SCHEDULE
- EXISTING MASONRY WALL

REFER TO ENGINEER'S DETAIL

- TYPE A CONSTRUCTION SECTION BITUMINOUS CONSTRUCTION (ALONGSIDE ROAD)
- TYPE B CONSTRUCTION SECTION BITUMINOUS CONSTRUCTION (AWAY FROM ROAD)
- TYPE C CONSTRUCTION SECTION BOARDWALK CONSTRUCTION
- TYPE D CONSTRUCTION SECTION LOCAL BRIDGE
- PROPOSED FOOTPATH
- EXISTING RIVER / WATER COURSE
- EXISTING ROAD
- EXISTING FOOTPATH
- RAISED TABLE
- SPECIAL PROTECTION AREA (SPA)
- SPECIAL AREA OF CONSERVATION (SAC)
- FOR LANDSCAPE ZONES REFER TO LVIA DESCRIPTION LANDSCAPE TREATMENT

Note:
FOR CHAINAGE REFER TO ENGINEERING DRAWINGS

Unit 8
Block 660
Greenogue Business Plaza
Greenogue Business Park
Rathcoole
Dublin D24 CY64

T +353 (0)1 685 5595
E info@jbaconsulting.com
www.jbaconsulting.com
Twitter @JBAConsulting



Project **Boyne Greenway LVIA**

Title **Landscape Detailed Layout - Sheet -5**

Client **Meath County Council**

The property of this drawing and design vested in Jeremy Benn Associates Ltd. It shall not be reproduced in whole or in part, nor disclosed to a third party, without the prior written consent of Jeremy Benn Associates Ltd.

Drawn: CZ	01/03/2022	Designed: CZ	07/01/2022
Checked: CP	01/03/2022	Approved: BOC	01/03/2022
Project Reference: 2021s1306	Scale: 1:500 @ A1		
Drawing Number: GUK-JBAI-XX-XX-DR-L-0007	Status: A3	Revision: C01	Sheet Size: A1

CHAINAGE: 4370 - 4680

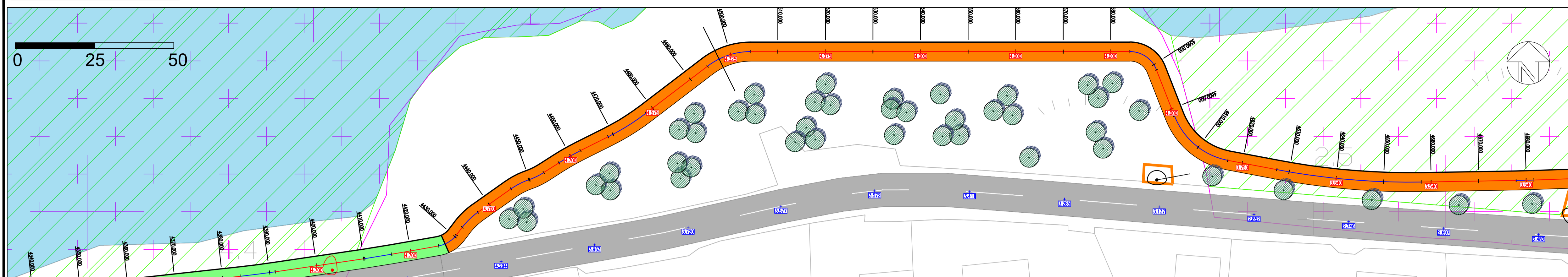

CHAINAGE: 4680 - 5010

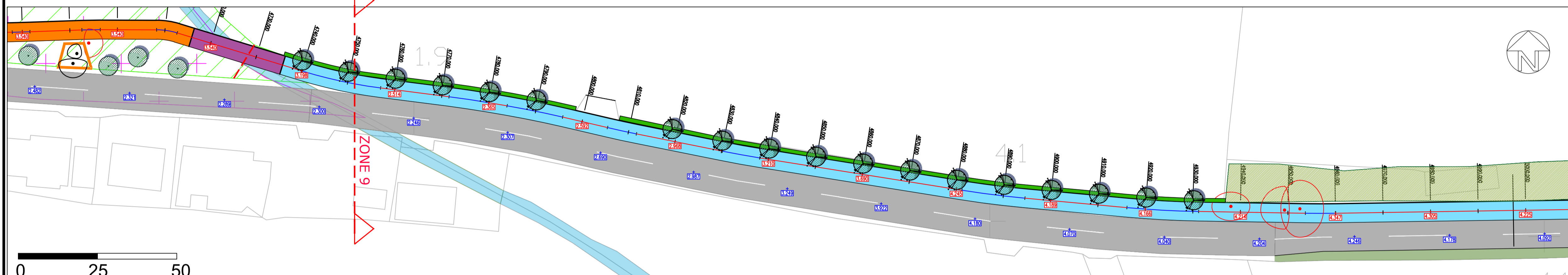

CHAINAGE: 5010 - 5330

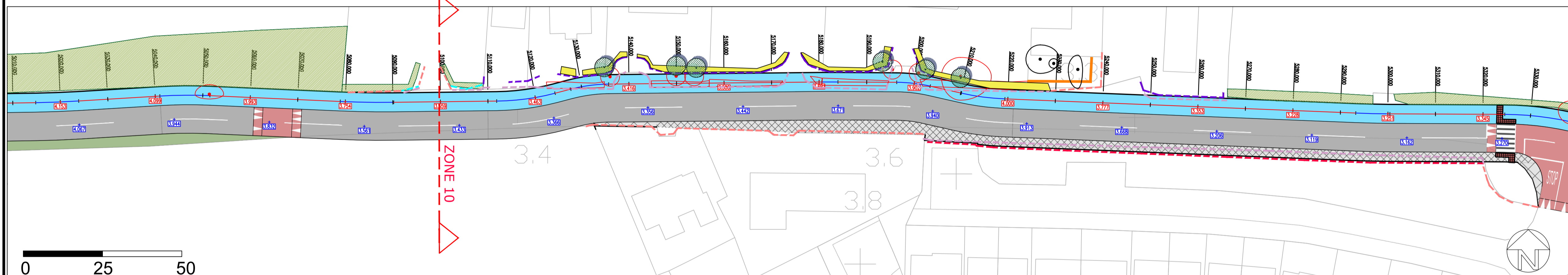

KEY PLAN CHAINAGE: 4370 - 5330

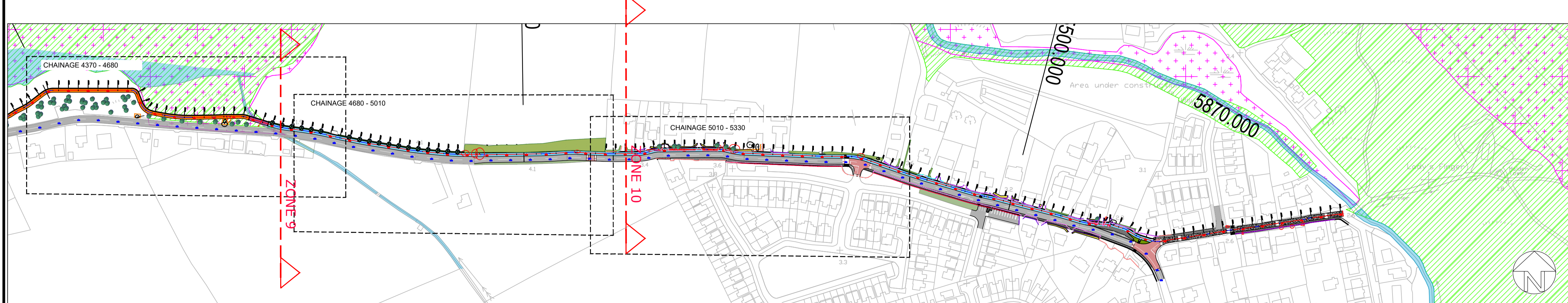

Legend

- SITE BOUNDARY
- EXISTING TREE TO BE RETAINED, REFER TO ARBORICULTURA SURVEY
- EXISTING TREE TO BE REMOVE, REFER TO ARBORICULTURA SURVEY
- TREE PROTECTION FENCING REFER TO ARBORICULTURA SURVEY
- EXISTING HEDGEROW TO BE RETAINED, REFER TO ARBORICULTURA SURVEY
- EXISTING HEDGEROW TO BE REMOVE, REFER TO ARBORICULTURA SURVEY
- PROPOSED NATIVE TREE PLANTING, REFER TO PLANTING SCHEDULE
- PROPOSED NATIVE WOODLAND PLANTING, REFER TO PLANTING SCHEDULE
- PROPOSED NATIVE LOW/MEDIUM SHRUB AND ORNAMENTAL GRASS PLANTING
- PROPOSED NATIVE HEDGEROW, REFER TO PLANTING SCHEDULE
- PROPOSED FORMAL HEDGE PLANTING TO EXISTING FRONT GARDEN REFER TO PLANTING SCHEDULE
- EXISTING BOUNDARY TREATMENT TO BE RETAINED
- EXISTING BOUNDARY TREATMENT TO BE REMOVED
- PROPOSED WALL RAILING ALONG THE MORNINGTON COURT
- PROPOSED NEW POST AND RAIL BOUNDARY TO EXISTING FRONT GARDEN
- PROPOSED NEW BOUNDARY WALL TO EXISTING FRONT GARDEN
- EXISTING MASONRY WALL
- REFER TO ENGINEER'S DETAIL**
- TYPE A CONSTRUCTION SECTION BITUMINOUS CONSTRUCTION (ALONGSIDE ROAD)
- TYPE B CONSTRUCTION SECTION BITUMINOUS CONSTRUCTION (AWAY FROM ROAD)
- TYPE C CONSTRUCTION SECTION BOARDWALK CONSTRUCTION
- TYPE D CONSTRUCTION SECTION LOCAL BRIDGE
- PROPOSED FOOTPATH
- EXISTING RIVER / WATER COURSE
- EXISTING ROAD
- EXISTING FOOTPATH
- RAISED TABLE
- SPECIAL PROTECTION AREA (SPA)
- SPECIAL AREA OF CONSERVATION (SAC)
- FOR LANDSCAPE ZONES REFER TO LVIA DESCRIPTION LANDSCAPE TREATMENT

Note:
FOR CHAINAGE REFER TO ENGINEERING DRAWINGS

Unit 8
Block 660
Greenogue Business Plaza
Greenogue Business Park
Rathcoole
Dublin D24 CY64
T +353 (0)1 685 5595
E info@jbaconsulting.com
www.jbaconsulting.com
Twitter @JBAConsulting



Project **Boyne Greenway LVIA**

Title **Landscape Detailed Layout - Sheet -6**
for

Client **Meath County Council**

The property of this drawing and design vested in Jeremy Benn Associates Ltd. It shall not be reproduced in whole or in part, nor disclosed to a third party, without the prior written consent of Jeremy Benn Associates Ltd.

Drawn: CZ	01/03/2022	Designed: CZ	16/02/2022
Checked: CP	01/03/2022	Approved: BOC	01/03/2022
Project Reference: 2021s1306	Scale: 1:500 @ A1		
Drawing Number: GUK-JBAI-XX-XX-DR-L-0008	Status: A3	Revision: C01	Sheet Size: A1

CHAINAGE: 5330 - 5590



CHAINAGE: 5590 - 5867



KEY PLAN CHAINAGE: 5330 - 5867

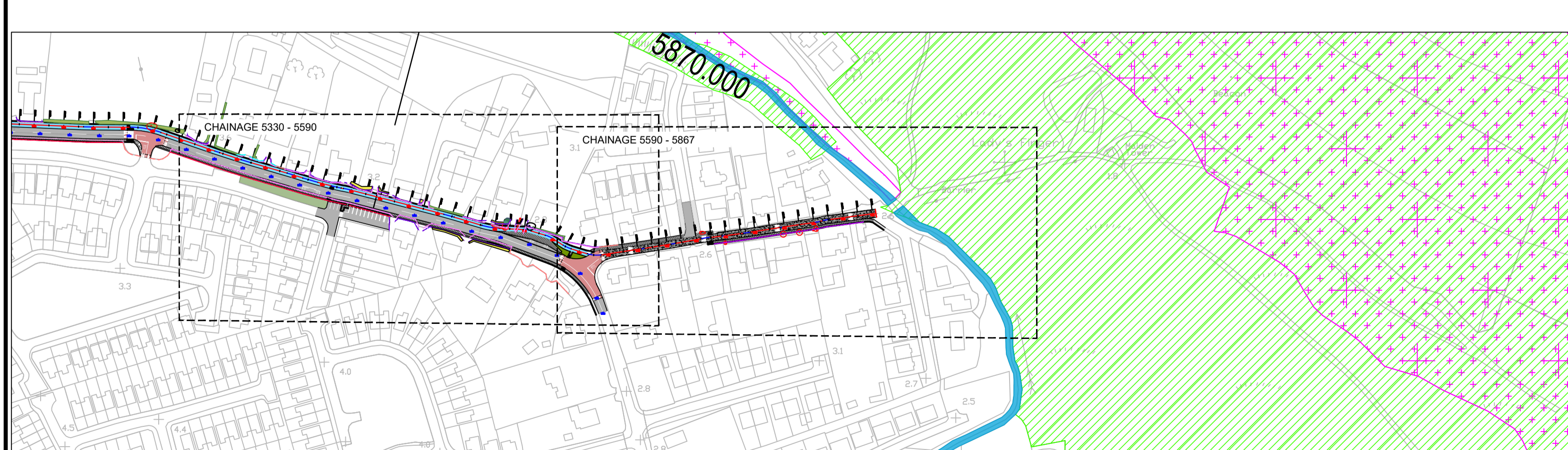

Legend

- SITE BOUNDARY
- EXISTING TREE TO BE RETAINED, REFER TO ARBORICULTURA SURVEY
- EXISTING TREE TO BE REMOVE, REFER TO ARBORICULTURA SURVEY
- TREE PROTECTION FENCING REFER TO ARBORICULTURA SURVEY
- EXISTING HEDGEROW TO BE RETAINED, REFER TO ARBORICULTURA SURVEY
- EXISTING HEDGEROW TO BE REMOVE, REFER TO ARBORICULTURA SURVEY
- PROPOSED NATIVE TREE PLANTING, REFER TO PLANTING SCHEDULE
- PROPOSED NATIVE WOODLAND PLANTING, REFER TO PLANTING SCHEDULE
- PROPOSED NATIVE LOW/MEDIUM SHRUB AND ORNAMENTAL GRASS PLANTING
- PROPOSED NATIVE HEDGEROW, REFER TO PLANTING SCHEDULE
- PROPOSED FORMAL HEDGE PLANTING TO EXISTING FRONT GARDEN REFER TO PLANTING SCHEDULE
- EXISTING BOUNDARY TREATMENT TO BE RETAINED
- EXISTING BOUNDARY TREATMENT TO BE REMOVED
- PROPOSED WALL RAILING ALONG THE MORNINGTON COURT
- PROPOSED NEW POST AND RAIL BOUNDARY TO EXISTING FRONT GARDEN
- PROPOSED NEW BOUNDARY WALL TO EXISTING FRONT GARDEN
- EXISTING MASONRY WALL
- REFER TO ENGINEER'S DETAIL
- TYPE A CONSTRUCTION SECTION BITUMINOUS CONSTRUCTION (ALONGSIDE ROAD)
- TYPE B CONSTRUCTION SECTION BITUMINOUS CONSTRUCTION (AWAY FROM ROAD)
- TYPE C CONSTRUCTION SECTION BOARDWALK CONSTRUCTION
- TYPE D CONSTRUCTION SECTION LOCAL BRIDGE
- PROPOSED FOOTPATH
- EXISTING RIVER / WATER COURSE
- EXISTING ROAD
- EXISTING FOOTPATH
- RAISED TABLE
- SPECIAL PROTECTION AREA (SPA)
- SPECIAL AREA OF CONSERVATION (SAC)
- FOR LANDSCAPE ZONES REFER TO LVIA DESCRIPTION LANDSCAPE TREATMENT

Note:
FOR CHAINAGE REFER TO ENGINEERING DRAWINGS

Unit 8
Block 660
Greenogue Business Plaza
Greenogue Business Park
Rathcoole
Dublin D24 CY64
T +353 (0)1 685 5595
E info@jbaconsulting.com
www.jbaconsulting.com
Twitter @JBAConsulting



Project **Boyne Greenway LVIA**

Title **Landscape Detailed Layout - Sheet -7**
for

Client **Meath County Council**

The property of this drawing and design vested in Jeremy Benn Associates Ltd. It shall not be reproduced in whole or in part, nor disclosed to a third party, without the prior written consent of Jeremy Benn Associates Ltd.

Drawn: CZ	01/03/2022	Designed: CZ	07/01/2022
Checked: CP	01/03/2022	Approved: BOC	01/03/2022
Project Reference: 2021s1306	Scale: 1:500 @ A1		
Drawing Number: GUK-JBAI-XX-XX-DR-L-0009	Status: A3	Revision: C01	Sheet Size: A1

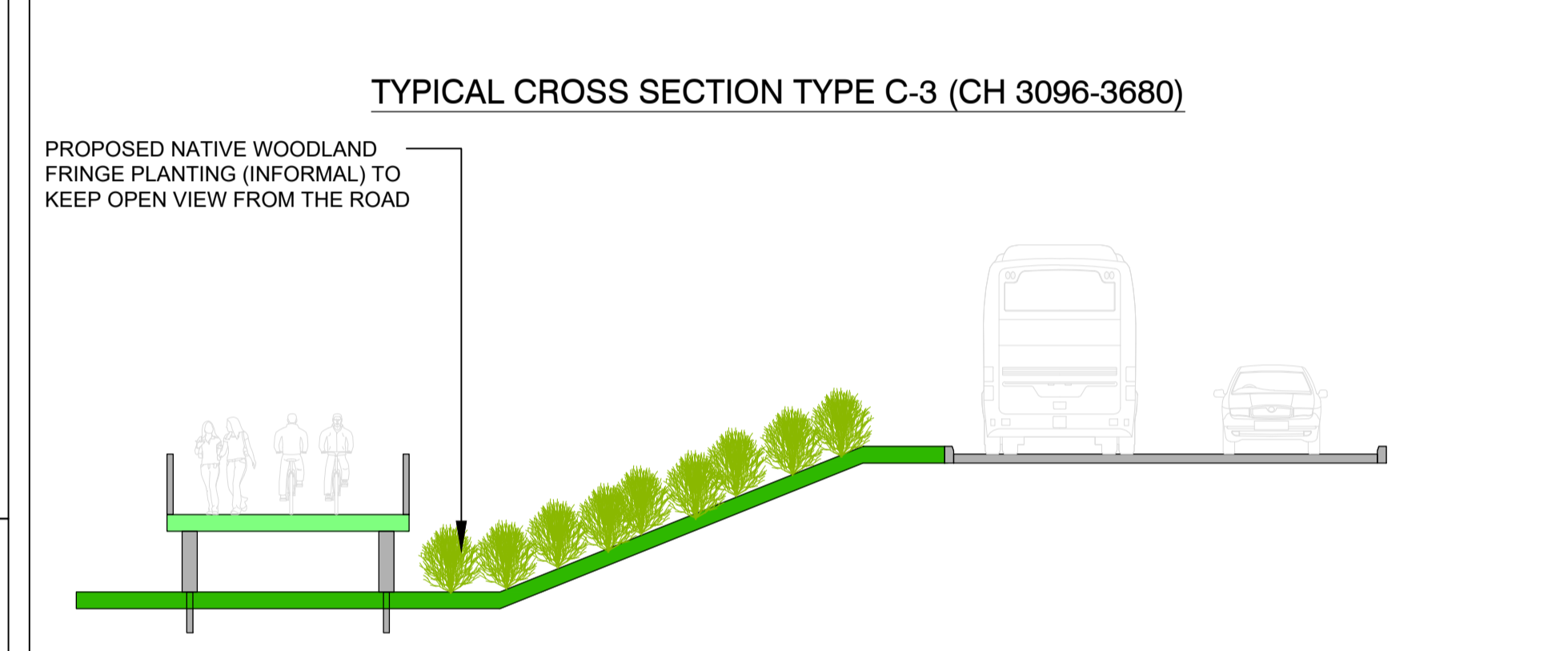
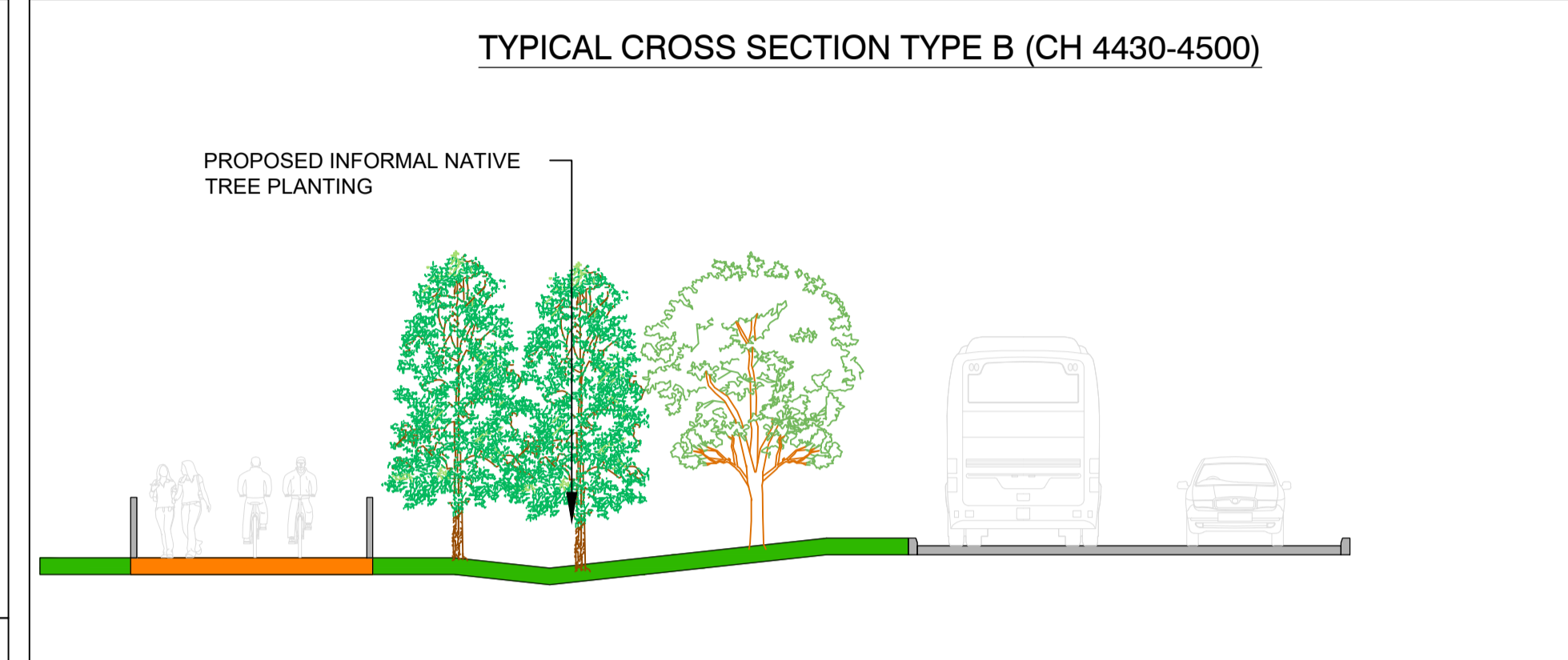
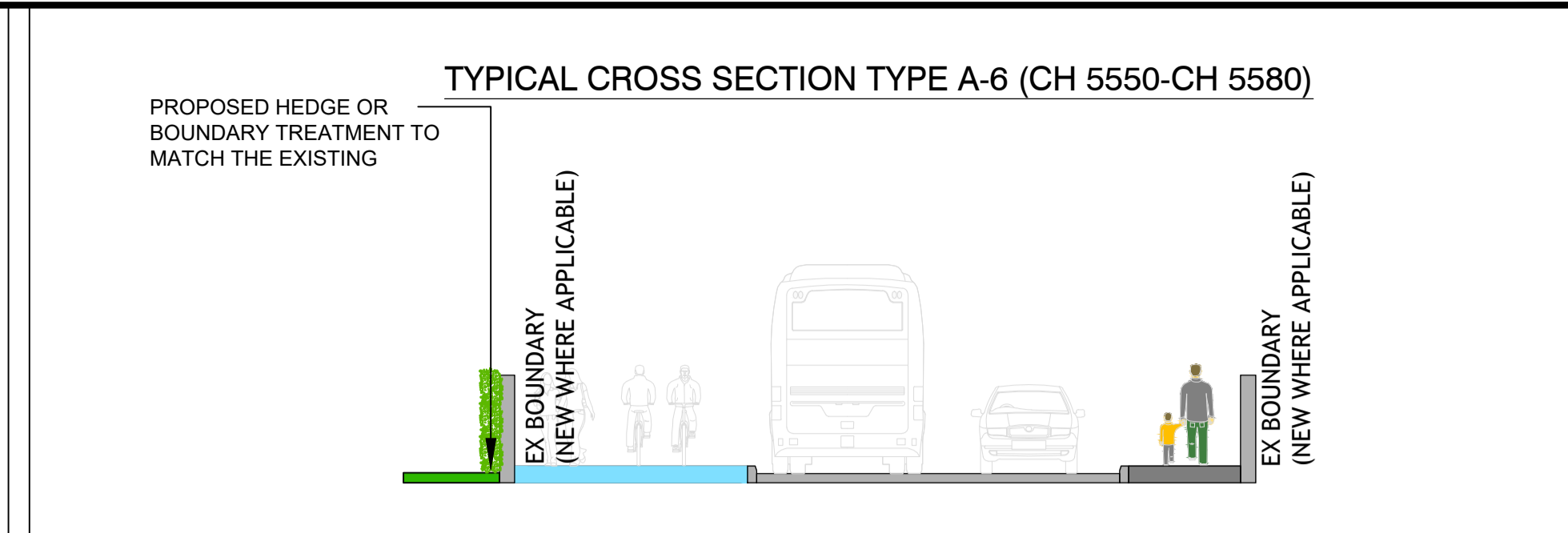
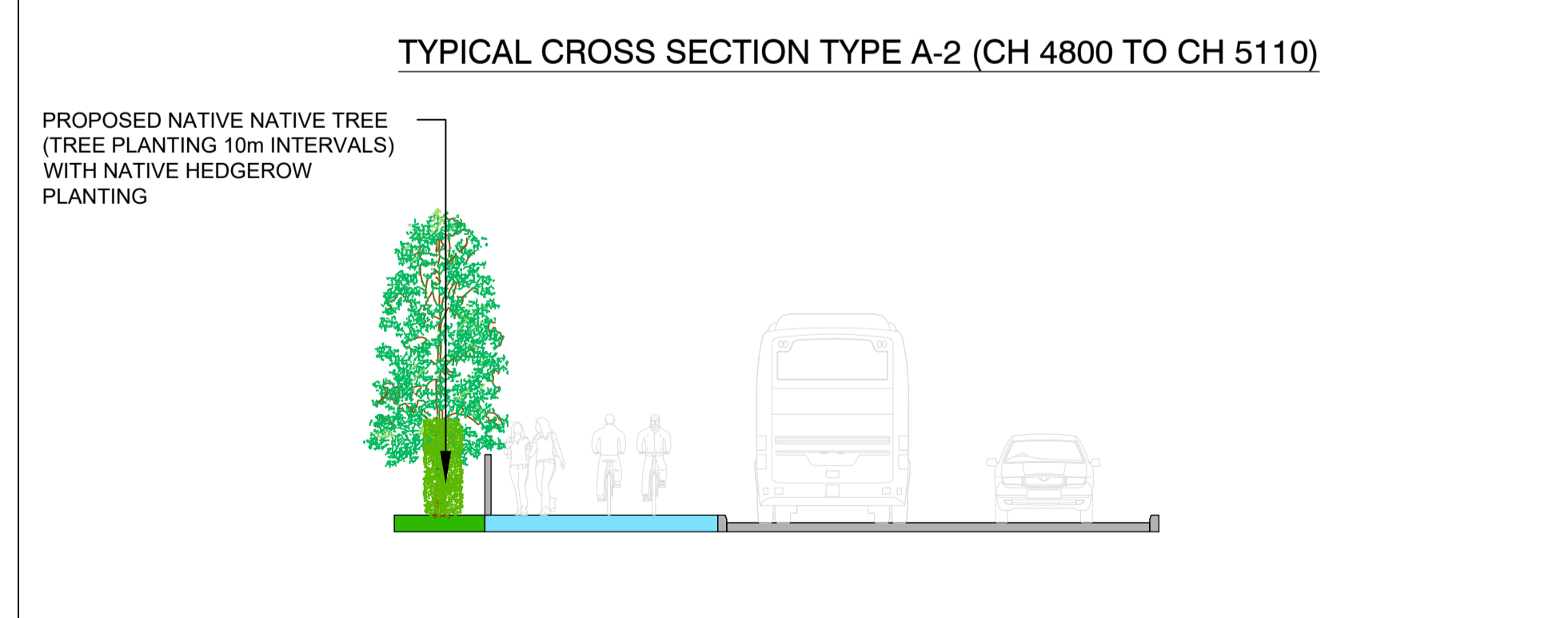
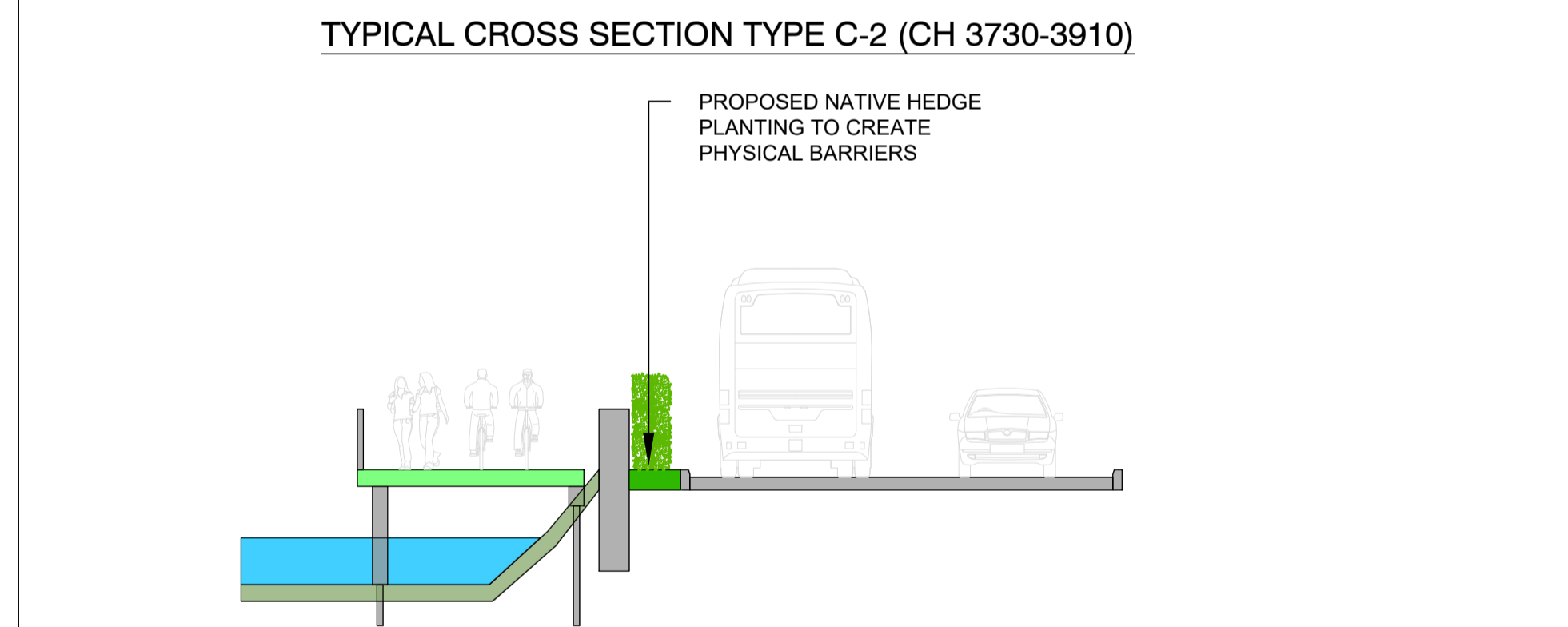
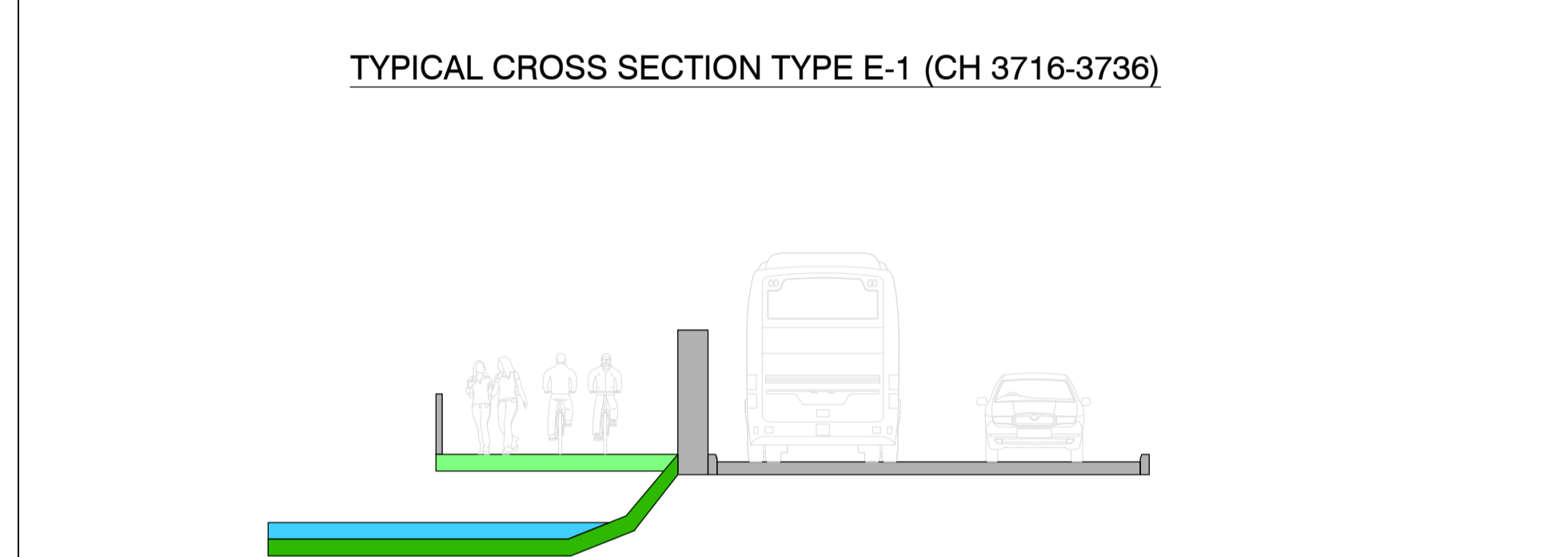
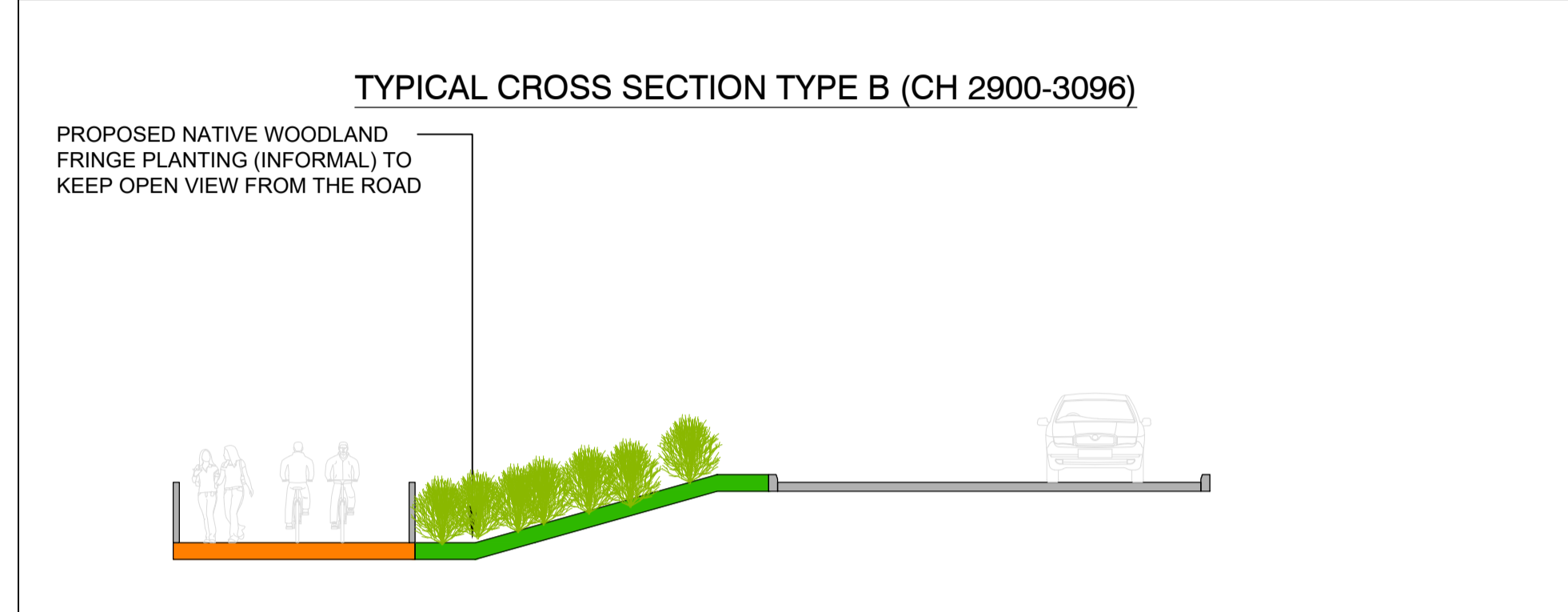
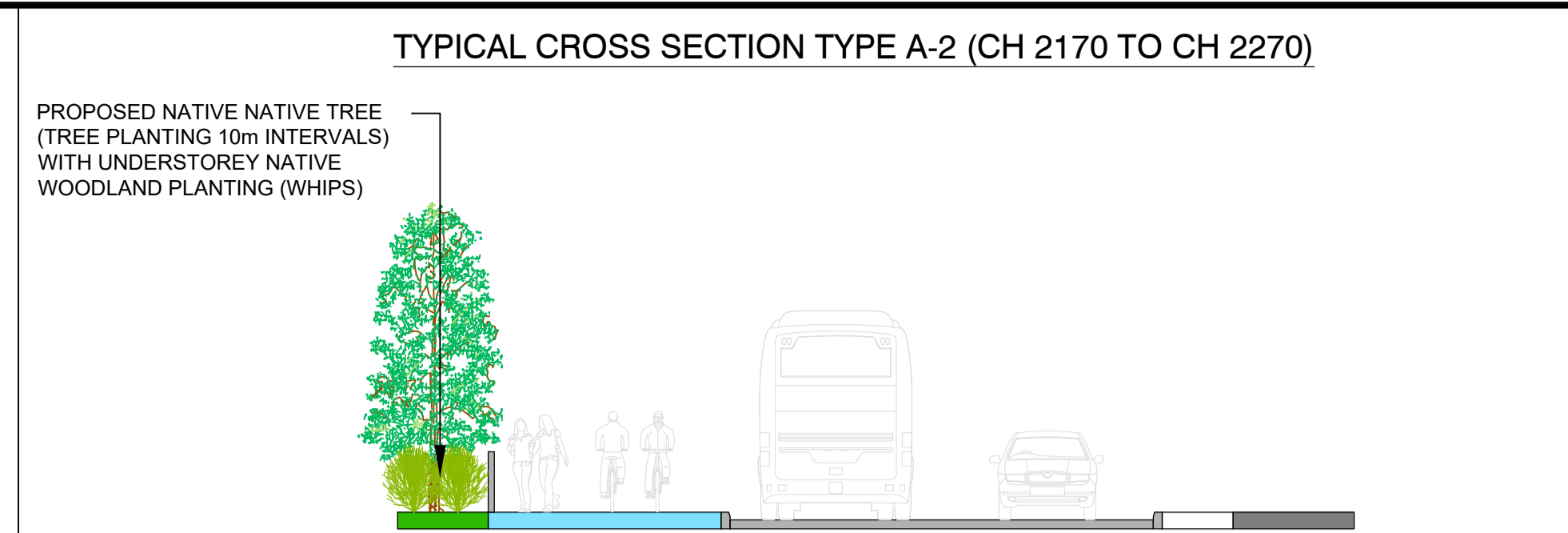
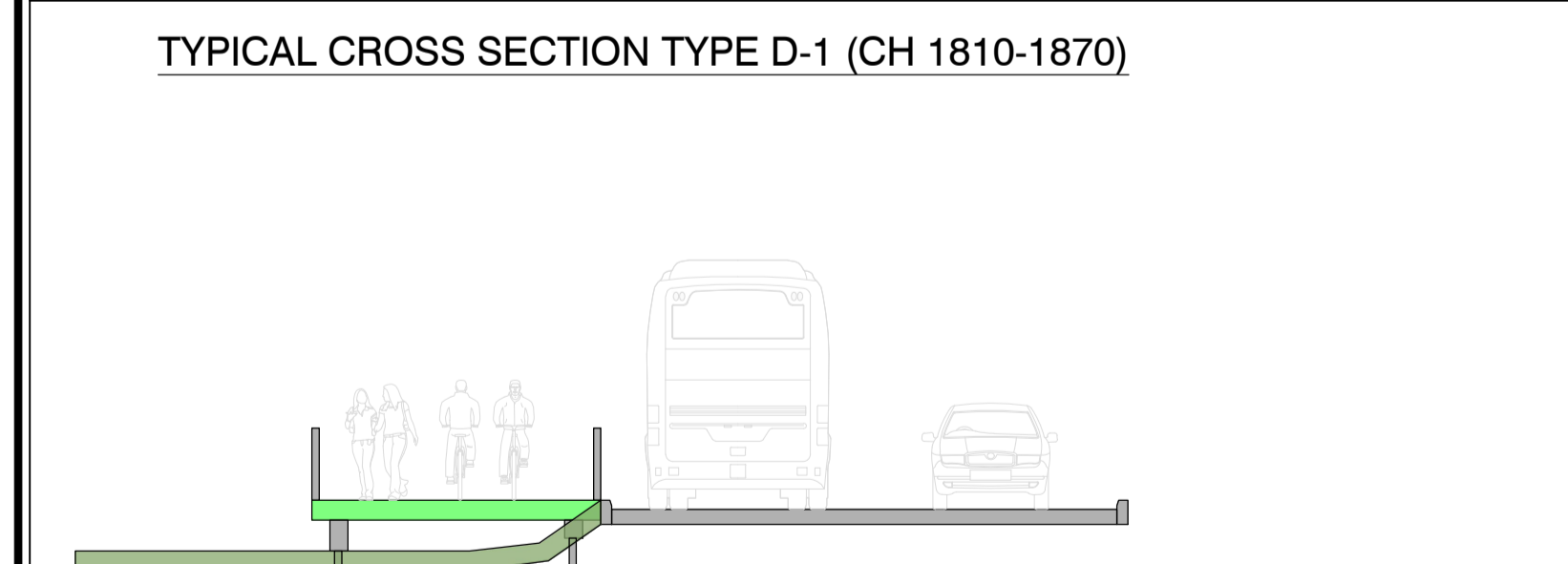
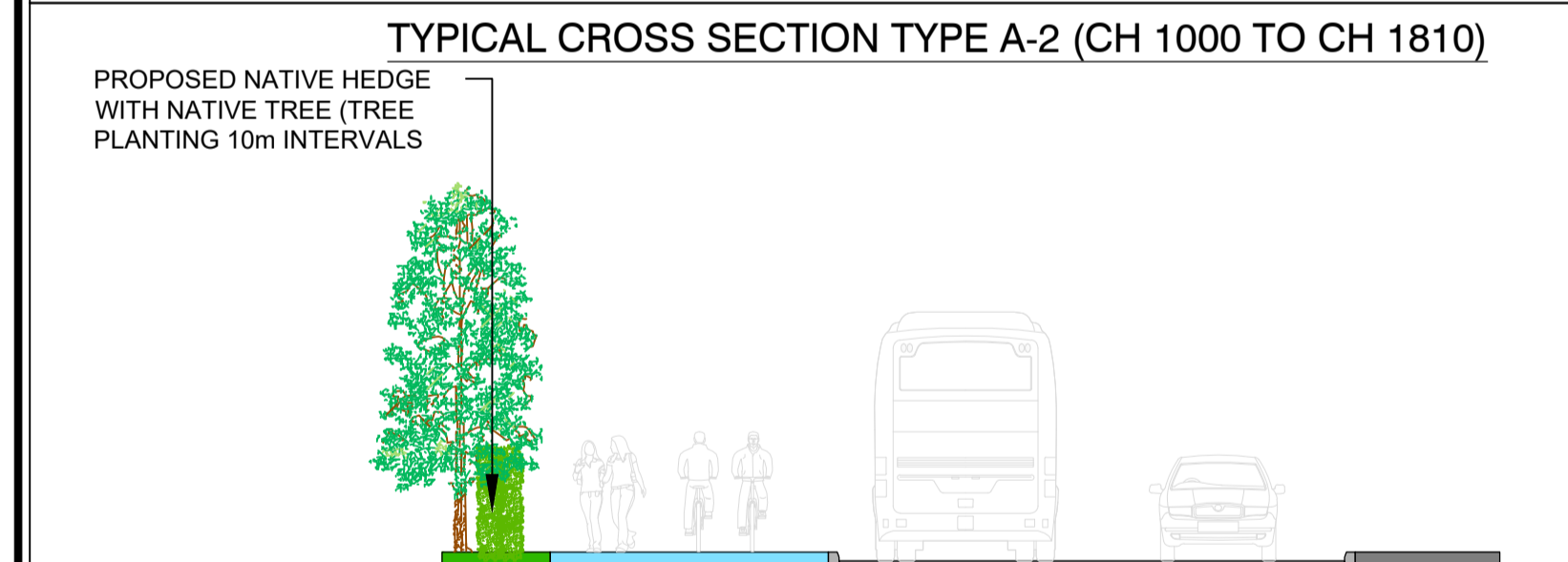
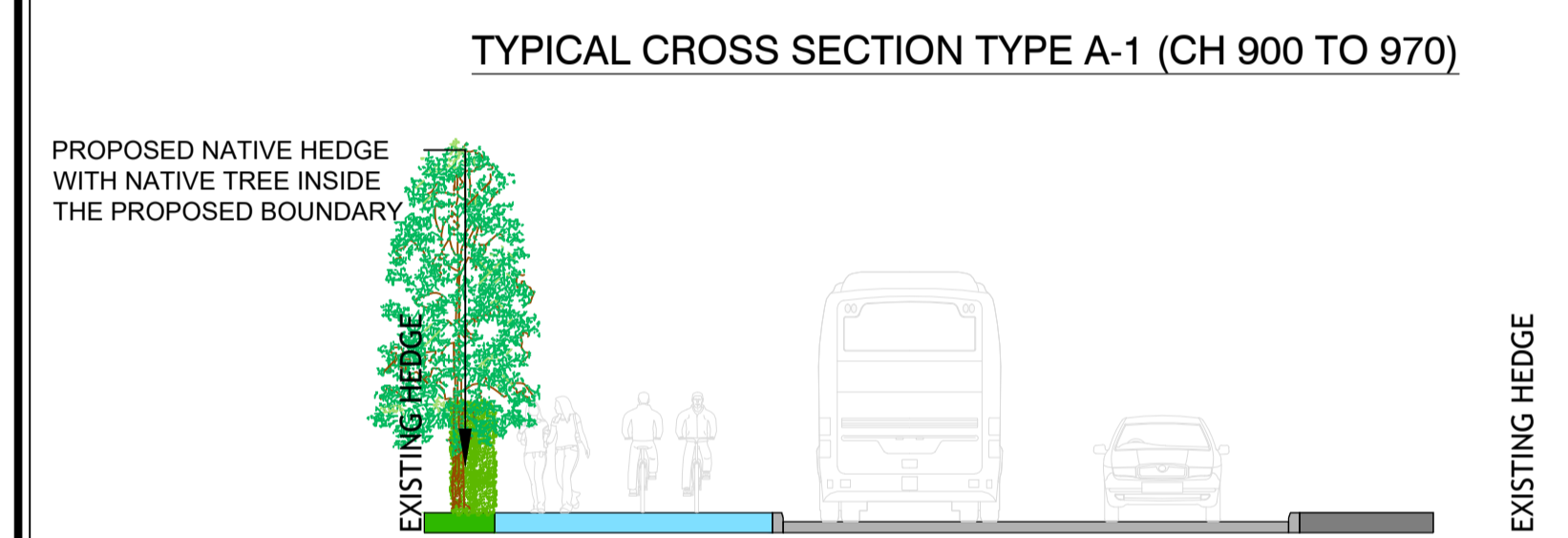
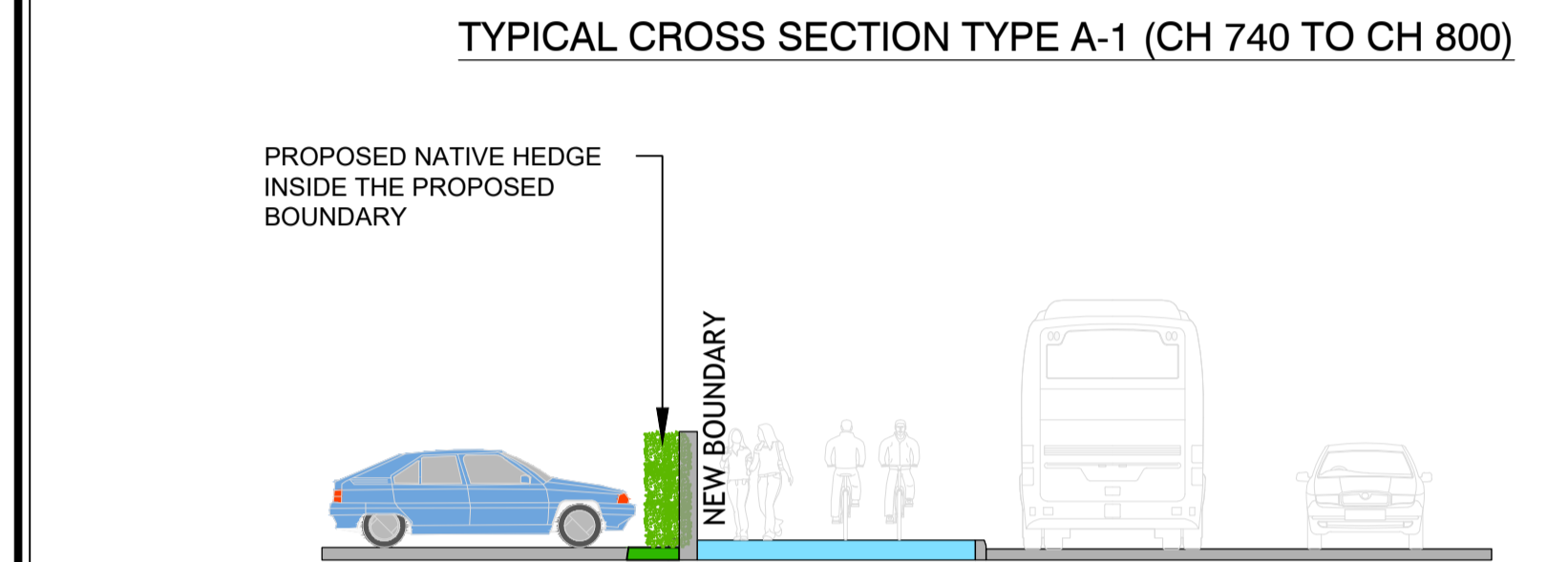
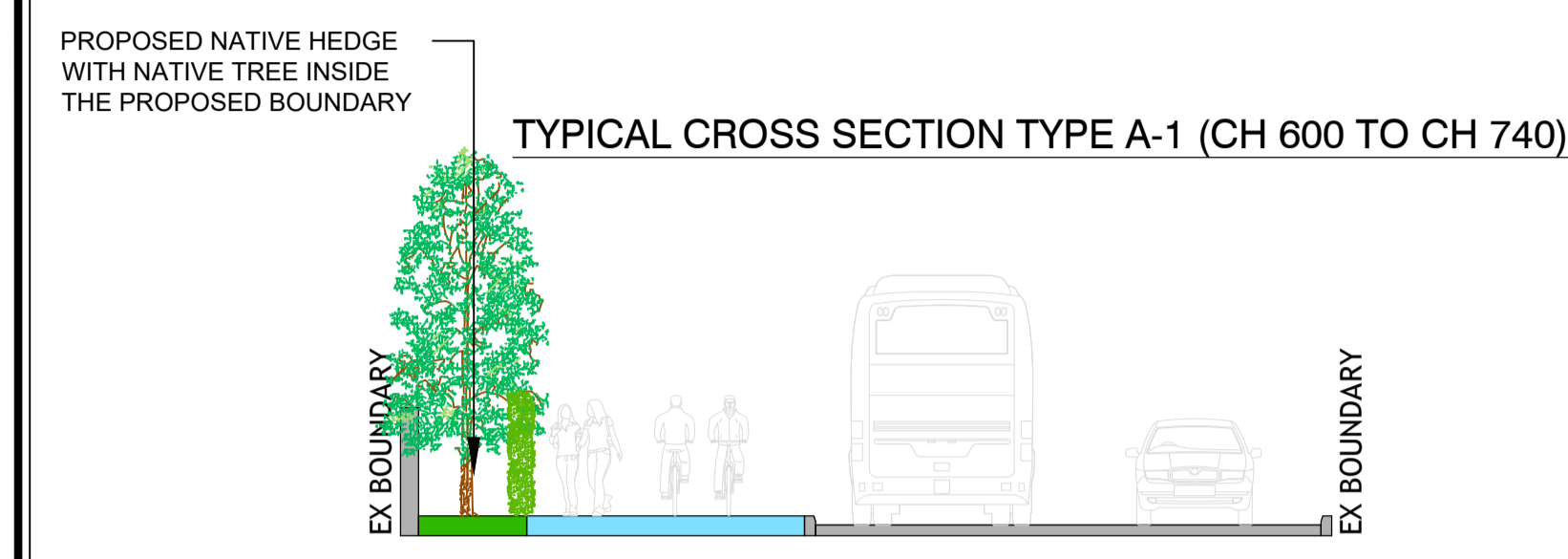
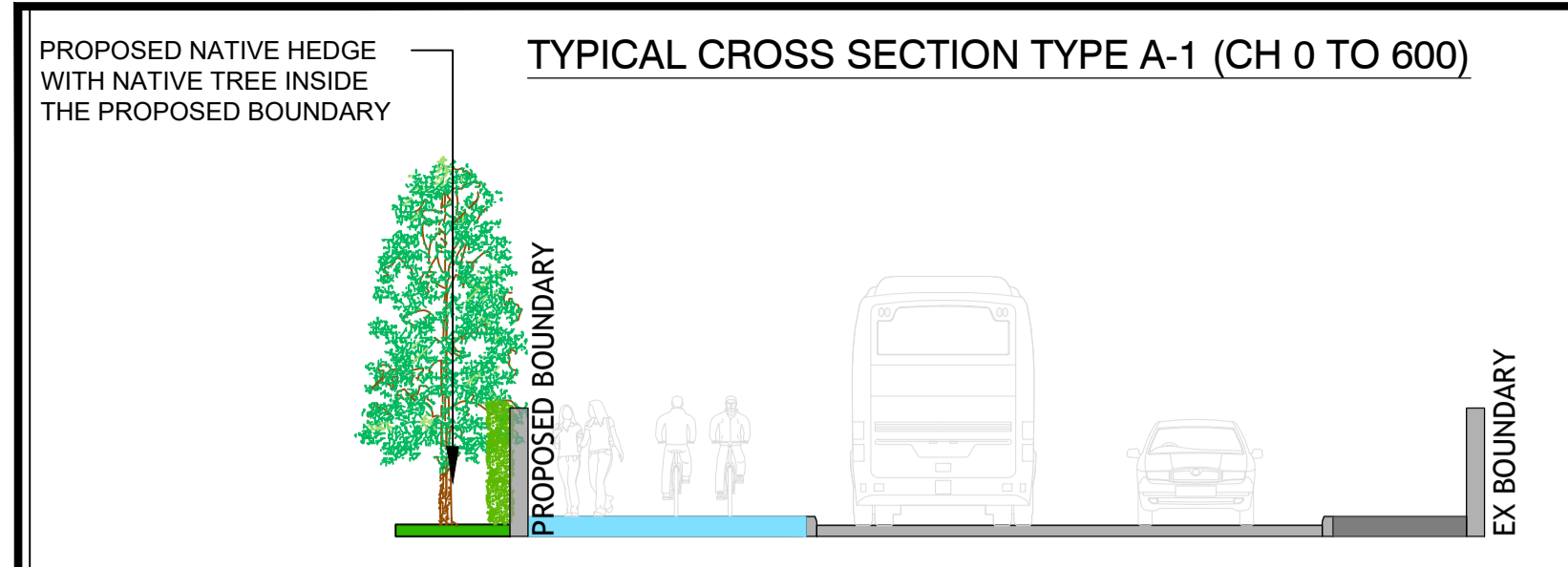

Unit 8
Block 660
Greenogue Business Plaza
Greenogue Business Park
Rathcoole
Dublin D24 CY64

T +353 (0)1 685 5595
E info@jbaconsulting.com
www.jbaconsulting.com
Twitter @JBAConsulting

Project **Boyne Greenway LVIA**

Title

Landscape Section
for

Client **Meath County Council**

The property of this drawing and design vested in Jeremy Benn Associates Ltd. It shall not be reproduced in whole or in part, nor disclosed to a third party, without the prior written consent of Jeremy Benn Associates Ltd.

Drawn: CZ	01/03/2022	Designed: CZ	07/01/2022
Checked: CP	01/03/2022	Approved: BOC	01/03/2022
Project Reference: 2021s1306	Scale: 1:100 @ A1		
Drawing Number: GUK-JBAI-XX-XX-DR-L-0010	Status: A3	Revision: C01	Sheet Size: A1

